



February 2011
Layout Library

© Agilent Technologies, Inc. 2000-2011

5301 Stevens Creek Blvd., Santa Clara, CA 95052 USA

No part of this documentation may be reproduced in any form or by any means (including electronic storage and retrieval or translation into a foreign language) without prior agreement and written consent from Agilent Technologies, Inc. as governed by United States and international copyright laws.

Acknowledgments

Mentor Graphics is a trademark of Mentor Graphics Corporation in the U.S. and other countries. Mentor products and processes are registered trademarks of Mentor Graphics Corporation. * Calibre is a trademark of Mentor Graphics Corporation in the US and other countries. "Microsoft®, Windows®, MS Windows®, Windows NT®, Windows 2000® and Windows Internet Explorer® are U.S. registered trademarks of Microsoft Corporation. Pentium® is a U.S. registered trademark of Intel Corporation. PostScript® and Acrobat® are trademarks of Adobe Systems Incorporated. UNIX® is a registered trademark of the Open Group. Oracle and Java and registered trademarks of Oracle and/or its affiliates. Other names may be trademarks of their respective owners. SystemC® is a registered trademark of Open SystemC Initiative, Inc. in the United States and other countries and is used with permission. MATLAB® is a U.S. registered trademark of The Math Works, Inc.. HiSIM2 source code, and all copyrights, trade secrets or other intellectual property rights in and to the source code in its entirety, is owned by Hiroshima University and STARC. FLEXIm is a trademark of Globetrotter Software, Incorporated. Layout Boolean Engine by Klaas Holwerda, v1.7 <http://www.xs4all.nl/~kholwerd/bool.html> . FreeType Project, Copyright (c) 1996-1999 by David Turner, Robert Wilhelm, and Werner Lemberg. QuestAgent search engine (c) 2000-2002, JObjects. Motif is a trademark of the Open Software Foundation. Netscape is a trademark of Netscape Communications Corporation. Netscape Portable Runtime (NSPR), Copyright (c) 1998-2003 The Mozilla Organization. A copy of the Mozilla Public License is at <http://www.mozilla.org/MPL/> . FFTW, The Fastest Fourier Transform in the West, Copyright (c) 1997-1999 Massachusetts Institute of Technology. All rights reserved.

The following third-party libraries are used by the NlogN Momentum solver:

"This program includes Metis 4.0, Copyright © 1998, Regents of the University of Minnesota", <http://www.cs.umn.edu/~metis> , METIS was written by George Karypis (karypis@cs.umn.edu).

Intel@ Math Kernel Library, <http://www.intel.com/software/products/mkl>

SuperLU_MT version 2.0 - Copyright © 2003, The Regents of the University of California, through Lawrence Berkeley National Laboratory (subject to receipt of any required approvals from U.S. Dept. of Energy). All rights reserved. SuperLU Disclaimer: THIS SOFTWARE IS PROVIDED BY THE COPYRIGHT HOLDERS AND CONTRIBUTORS "AS IS" AND ANY EXPRESS OR IMPLIED WARRANTIES, INCLUDING, BUT NOT LIMITED TO, THE IMPLIED WARRANTIES OF MERCHANTABILITY AND FITNESS FOR A PARTICULAR PURPOSE ARE DISCLAIMED. IN NO EVENT SHALL THE COPYRIGHT OWNER OR CONTRIBUTORS BE LIABLE FOR ANY DIRECT, INDIRECT, INCIDENTAL, SPECIAL, EXEMPLARY, OR CONSEQUENTIAL DAMAGES (INCLUDING, BUT NOT LIMITED TO, PROCUREMENT OF SUBSTITUTE GOODS OR SERVICES; LOSS OF USE, DATA, OR PROFITS; OR BUSINESS INTERRUPTION) HOWEVER CAUSED AND ON ANY THEORY OF LIABILITY, WHETHER IN

CONTRACT, STRICT LIABILITY, OR TORT (INCLUDING NEGLIGENCE OR OTHERWISE) ARISING IN ANY WAY OUT OF THE USE OF THIS SOFTWARE, EVEN IF ADVISED OF THE POSSIBILITY OF SUCH DAMAGE.

7-zip - 7-Zip Copyright: Copyright (C) 1999-2009 Igor Pavlov. Licenses for files are: 7z.dll: GNU LGPL + unRAR restriction, All other files: GNU LGPL. 7-zip License: This library is free software; you can redistribute it and/or modify it under the terms of the GNU Lesser General Public License as published by the Free Software Foundation; either version 2.1 of the License, or (at your option) any later version. This library is distributed in the hope that it will be useful, but WITHOUT ANY WARRANTY; without even the implied warranty of MERCHANTABILITY or FITNESS FOR A PARTICULAR PURPOSE. See the GNU Lesser General Public License for more details. You should have received a copy of the GNU Lesser General Public License along with this library; if not, write to the Free Software Foundation, Inc., 59 Temple Place, Suite 330, Boston, MA 02111-1307 USA. unRAR copyright: The decompression engine for RAR archives was developed using source code of unRAR program. All copyrights to original unRAR code are owned by Alexander Roshal. unRAR License: The unRAR sources cannot be used to re-create the RAR compression algorithm, which is proprietary. Distribution of modified unRAR sources in separate form or as a part of other software is permitted, provided that it is clearly stated in the documentation and source comments that the code may not be used to develop a RAR (WinRAR) compatible archiver. 7-zip Availability: <http://www.7-zip.org/>

AMD Version 2.2 - AMD Notice: The AMD code was modified. Used by permission. AMD copyright: AMD Version 2.2, Copyright © 2007 by Timothy A. Davis, Patrick R. Amestoy, and Iain S. Duff. All Rights Reserved. AMD License: Your use or distribution of AMD or any modified version of AMD implies that you agree to this License. This library is free software; you can redistribute it and/or modify it under the terms of the GNU Lesser General Public License as published by the Free Software Foundation; either version 2.1 of the License, or (at your option) any later version. This library is distributed in the hope that it will be useful, but WITHOUT ANY WARRANTY; without even the implied warranty of MERCHANTABILITY or FITNESS FOR A PARTICULAR PURPOSE. See the GNU Lesser General Public License for more details. You should have received a copy of the GNU Lesser General Public License along with this library; if not, write to the Free Software Foundation, Inc., 51 Franklin St, Fifth Floor, Boston, MA 02110-1301 USA Permission is hereby granted to use or copy this program under the terms of the GNU LGPL, provided that the Copyright, this License, and the Availability of the original version is retained on all copies. User documentation of any code that uses this code or any modified version of this code must cite the Copyright, this License, the Availability note, and "Used by permission." Permission to modify the code and to distribute modified code is granted, provided the Copyright, this License, and the Availability note are retained, and a notice that the code was modified is included. AMD Availability: <http://www.cise.ufl.edu/research/sparse/amd>

UMFPACK 5.0.2 - UMFPACK Notice: The UMFPACK code was modified. Used by permission. UMFPACK Copyright: UMFPACK Copyright © 1995-2006 by Timothy A. Davis. All Rights Reserved. UMFPACK License: Your use or distribution of UMFPACK or any modified version of UMFPACK implies that you agree to this License. This library is free software; you can redistribute it and/or modify it under the terms of the GNU Lesser General Public License as published by the Free Software Foundation; either version 2.1 of the License, or (at your option) any later version. This library is distributed in the hope that it will be useful, but WITHOUT ANY WARRANTY; without even the implied warranty of MERCHANTABILITY

or FITNESS FOR A PARTICULAR PURPOSE. See the GNU Lesser General Public License for more details. You should have received a copy of the GNU Lesser General Public License along with this library; if not, write to the Free Software Foundation, Inc., 51 Franklin St, Fifth Floor, Boston, MA 02110-1301 USA Permission is hereby granted to use or copy this program under the terms of the GNU LGPL, provided that the Copyright, this License, and the Availability of the original version is retained on all copies. User documentation of any code that uses this code or any modified version of this code must cite the Copyright, this License, the Availability note, and "Used by permission." Permission to modify the code and to distribute modified code is granted, provided the Copyright, this License, and the Availability note are retained, and a notice that the code was modified is included. UMFPACK Availability: <http://www.cise.ufl.edu/research/sparse/umfpack> UMFPACK (including versions 2.2.1 and earlier, in FORTRAN) is available at <http://www.cise.ufl.edu/research/sparse> . MA38 is available in the Harwell Subroutine Library. This version of UMFPACK includes a modified form of COLAMD Version 2.0, originally released on Jan. 31, 2000, also available at <http://www.cise.ufl.edu/research/sparse> . COLAMD V2.0 is also incorporated as a built-in function in MATLAB version 6.1, by The MathWorks, Inc. <http://www.mathworks.com> . COLAMD V1.0 appears as a column-preordering in SuperLU (SuperLU is available at <http://www.netlib.org>). UMFPACK v4.0 is a built-in routine in MATLAB 6.5. UMFPACK v4.3 is a built-in routine in MATLAB 7.1.

Qt Version 4.6.3 - Qt Notice: The Qt code was modified. Used by permission. Qt copyright: Qt Version 4.6.3, Copyright (c) 2010 by Nokia Corporation. All Rights Reserved. Qt License: Your use or distribution of Qt or any modified version of Qt implies that you agree to this License. This library is free software; you can redistribute it and/or modify it under the terms of the GNU Lesser General Public License as published by the Free Software Foundation; either version 2.1 of the License, or (at your option) any later version. This library is distributed in the hope that it will be useful, but WITHOUT ANY WARRANTY; without even the implied warranty of MERCHANTABILITY or FITNESS FOR A PARTICULAR PURPOSE. See the GNU Lesser General Public License for more details. You should have received a copy of the GNU Lesser General Public License along with this library; if not, write to the Free Software Foundation, Inc., 51 Franklin St, Fifth Floor, Boston, MA 02110-1301 USA Permission is hereby granted to use or copy this program under the terms of the GNU LGPL, provided that the Copyright, this License, and the Availability of the original version is retained on all copies. User documentation of any code that uses this code or any modified version of this code must cite the Copyright, this License, the Availability note, and "Used by permission." Permission to modify the code and to distribute modified code is granted, provided the Copyright, this License, and the Availability note are retained, and a notice that the code was modified is included. Qt Availability: <http://www.qtsoftware.com/downloads> Patches Applied to Qt can be found in the installation at: `$HPEESOF_DIR/prod/licenses/thirdparty/qt/patches`. You may also contact Brian Buchanan at Agilent Inc. at brian_buchanan@agilent.com for more information.

The HiSIM_HV source code, and all copyrights, trade secrets or other intellectual property rights in and to the source code, is owned by Hiroshima University and/or STARC.

Errata The ADS product may contain references to "HP" or "HPEESOF" such as in file names and directory names. The business entity formerly known as "HP EEsof" is now part of Agilent Technologies and is known as "Agilent EEsof". To avoid broken functionality and

to maintain backward compatibility for our customers, we did not change all the names and labels that contain "HP" or "HPEESOF" references.

Warranty The material contained in this document is provided "as is", and is subject to being changed, without notice, in future editions. Further, to the maximum extent permitted by applicable law, Agilent disclaims all warranties, either express or implied, with regard to this documentation and any information contained herein, including but not limited to the implied warranties of merchantability and fitness for a particular purpose. Agilent shall not be liable for errors or for incidental or consequential damages in connection with the furnishing, use, or performance of this document or of any information contained herein. Should Agilent and the user have a separate written agreement with warranty terms covering the material in this document that conflict with these terms, the warranty terms in the separate agreement shall control.

Technology Licenses The hardware and/or software described in this document are furnished under a license and may be used or copied only in accordance with the terms of such license. Portions of this product include the SystemC software licensed under Open Source terms, which are available for download at <http://systemc.org/> . This software is redistributed by Agilent. The Contributors of the SystemC software provide this software "as is" and offer no warranty of any kind, express or implied, including without limitation warranties or conditions or title and non-infringement, and implied warranties or conditions merchantability and fitness for a particular purpose. Contributors shall not be liable for any damages of any kind including without limitation direct, indirect, special, incidental and consequential damages, such as lost profits. Any provisions that differ from this disclaimer are offered by Agilent only.

Restricted Rights Legend U.S. Government Restricted Rights. Software and technical data rights granted to the federal government include only those rights customarily provided to end user customers. Agilent provides this customary commercial license in Software and technical data pursuant to FAR 12.211 (Technical Data) and 12.212 (Computer Software) and, for the Department of Defense, DFARS 252.227-7015 (Technical Data - Commercial Items) and DFARS 227.7202-3 (Rights in Commercial Computer Software or Computer Software Documentation).

Fixed Artwork	10
Using fixed artwork cells	10
Available fixed artwork cells	10
1D2J1A	13
2D3H1A	13
2D3J1C	14
2D7C1A	14
145MILXP	15
145ML4PK	15
AFLANGE	15
AK	16
ALMK	16
ALMK2	17
AP	17
AQ	18
ATCCAP	18
ATF36	18
ATF70	19
ATF76	19
ATF84	20
ATF86	20
AVNK35	21
AVNK70	21
AVNK85	22
AVNK86	22
AXIAL_L	23
AXIAL_M	23
AXRES	23
AXRES2	24
AXRES3	24
BFLANGE	24
C145D01	25
C211D07	25
C211D07V2	26
C221CD02	26
C244D04	27
C249D05	27
C305D01	28
C317D02	28
C319BD01	29
C319D06	29
C369D03	29
C744AD01	30
C751D03	30
C2003	31
C2904	31
C5102	32
C7904	32
C18202	32
C30301	33
CD	33

CERECX	34
CERECXF	34
CHPCAP	35
CHPRES	35
C-LL	35
C-LR	36
COIL1	36
C-UL	37
C-UR	37
DISK_L	37
DISK_M	38
DISK_S	38
GD4	38
GD7	39
GD9	39
GD11	40
GD16	40
GF1	41
GF4	41
GF7	42
GF11	42
GF21	43
HP70GT	43
HP85PLAS	44
HPAC100	44
HPAC100X	45
HPAC200	45
HPAC200V2	46
LG	46
LLD	47
M205	47
M253	48
MACROT	48
MACROX	48
ME	49
MICROX	49
MOP	50
MW4	50
MWT70	51
MWT71	51
MWT73	52
NEC01	52
NEC03	53
NEC07	53
NEC08	54
NEC12	54
NEC13	55
NEC14	55
NEC15	56
NEC18	56
NEC19	57

NEC20	57
NEC30	58
NEC32	58
NEC33	59
NEC34	59
NEC35	60
NEC37	60
NEC38	61
NEC39	61
NEC53E	61
NEC75	62
NEC83	62
NEC84	63
NEC84A	63
NEC87	64
NEC89	64
NEC89A	65
OKI_1	65
PFLANGE	65
RADIAL_L	66
RADIAL_M	66
RADIAL_S	66
RESA	67
SFLANGE	67
SMA_FEM	68
SMSMICROX	68
SOD80	69
SOD123	69
SOD323	70
SOT23	70
SOT23V2	70
SOT23V3	71
SOT23V4	71
SOT23V5	72
SOT23V6	72
SOT23V7	73
SOT23V8	73
SOT37	74
SOT89	74
SOT89V2	75
SOT103	75
SOT143	76
SOT143R	76
SOT143RV2	77
SOT143V2	77
SOT143V3	78
SOT143V4	78
SOT143V5	79
SOT143V6	79
SOT143V7	80
SOT223	80

SOT223V2	81
SOT323	81
SRP	82
TO39	82
TO72	83
TO72V2	83
TO92	84
TO117	84
TO206AA	85
TO206AF	85
TO226AA	86
TPLAST	86
TUNCAP	87
UMD	87
UPRIGHT	88
URP	88
WIRE0	88
WIRE1	89
Font Definitions	90
din17	90
iso3098	90
roman	90
smooth	91
italic	91
standard	92
gothic	92
math	93
sans	93
sansbold	94
filled	94
filledbold	95
straight	95
straightfilled	96
SMT Package Layout Artwork Library	97
Using SMT Package Artwork as Artwork Replacement	97
Ceramic Flat Pack (CFP) Packages	98
Chip and MELF Components	100
SOT, DPAK, D2PAK Packages	102
Plastic Flat Pack (PFP) Packages	104
Quad Flat Pack (QFP) Packages	105
Plastic Leaded Chip Carrier (PLCC)	108
Small Outline IC (SOIC)	109
Writing Customized SMT PAL Artwork	110

Fixed Artwork

Using fixed artwork cells

Fixed artwork provided with ADS 2011 is available in the ads_designs library. For information on

how to setup your component to use one of these fixed artwork designs, see

<http://edocs.soco.agilent.com/display/ads201101/Artwork#Artwork-AssociatingArtworkwithanItem>

Available fixed artwork cells

- *1D2J1A* (layout)
- *2D3H1A* (layout)
- *2D3J1C* (layout)
- *2D7C1A* (layout)
- *145MILXP* (layout)
- *145ML4PK* (layout)
- *AFLANGE* (layout)
- *AK* (layout)
- *ALMK* (layout)
- *ALMK2* (layout)
- *AP* (layout)
- *AQ* (layout)
- *ATCCAP* (layout)
- *ATF36* (layout)
- *ATF70* (layout)
- *ATF76* (layout)
- *ATF84* (layout)
- *ATF86* (layout)
- *AVNK35* (layout)
- *AVNK70* (layout)
- *AVNK85* (layout)
- *AVNK86* (layout)
- *AXIAL L* (layout)
- *AXIAL M* (layout)
- *AXRES* (layout)
- *AXRES2* (layout)
- *AXRES3* (layout)
- *BFLANGE* (layout)
- *C145D01* (layout)
- *C211D07* (layout)
- *C211D07V2* (layout)
- *C221CD02* (layout)
- *C244D04* (layout)
- *C249D05* (layout)
- *C305D01* (layout)
- *C317D02* (layout)
- *C319BD01* (layout)
- *C319D06* (layout)

- *C369D03* (layout)
- *C744AD01* (layout)
- *C751D03* (layout)
- *C2003* (layout)
- *C2904* (layout)
- *C5102* (layout)
- *C7904* (layout)
- *C18202* (layout)
- *C30301* (layout)
- *CD* (layout)
- *CERECX* (layout)
- *CERECXF* (layout)
- *CHPCAP* (layout)
- *CHPRES* (layout)
- *C-LL* (layout)
- *C-LR* (layout)
- *COIL1* (layout)
- *C-UL* (layout)
- *C-UR* (layout)
- *DISK L* (layout)
- *DISK M* (layout)
- *DISK S* (layout)
- *GD4* (layout)
- *GD7* (layout)
- *GD9* (layout)
- *GD11* (layout)
- *GD16* (layout)
- *GF1* (layout)
- *GF4* (layout)
- *GF7* (layout)
- *GF11* (layout)
- *GF21* (layout)
- *HP70GT* (layout)
- *HP85PLAS* (layout)
- *HPAC100* (layout)
- *HPAC100X* (layout)
- *HPAC200* (layout)
- *HPAC200V2* (layout)
- *LG* (layout)
- *LLD* (layout)
- *M205* (layout)
- *M253* (layout)
- *MACROT* (layout)
- *MACROX* (layout)
- *ME* (layout)
- *MICROX* (layout)
- *MOP* (layout)
- *MW4* (layout)
- *MWT70* (layout)
- *MWT71* (layout)
- *MWT73* (layout)

- *NEC01* (layout)
- *NEC03* (layout)
- *NEC07* (layout)
- *NEC08* (layout)
- *NEC12* (layout)
- *NEC13* (layout)
- *NEC14* (layout)
- *NEC15* (layout)
- *NEC18* (layout)
- *NEC19* (layout)
- *NEC20* (layout)
- *NEC30* (layout)
- *NEC32* (layout)
- *NEC33* (layout)
- *NEC34* (layout)
- *NEC35* (layout)
- *NEC37* (layout)
- *NEC38* (layout)
- *NEC39* (layout)
- *NEC53E* (layout)
- *NEC75* (layout)
- *NEC83* (layout)
- *NEC84* (layout)
- *NEC84A* (layout)
- *NEC87* (layout)
- *NEC89* (layout)
- *NEC89A* (layout)
- *OKI 1* (layout)
- *PFLANGE* (layout)
- *RADIAL L* (layout)
- *RADIAL M* (layout)
- *RADIAL S* (layout)
- *RESA* (layout)
- *SFLANGE* (layout)
- *SMA FEM* (layout)
- *SMSMICROX* (layout)
- *SOD80* (layout)
- *SOD123* (layout)
- *SOD323* (layout)
- *SOT23* (layout)
- *SOT23V2* (layout)
- *SOT23V3* (layout)
- *SOT23V4* (layout)
- *SOT23V5* (layout)
- *SOT23V6* (layout)
- *SOT23V7* (layout)
- *SOT23V8* (layout)
- *SOT37* (layout)
- *SOT89* (layout)
- *SOT89V2* (layout)
- *SOT103* (layout)

- SOT143 (layout)
- SOT143R (layout)
- SOT143RV2 (layout)
- SOT143V2 (layout)
- SOT143V3 (layout)
- SOT143V4 (layout)
- SOT143V5 (layout)
- SOT143V6 (layout)
- SOT143V7 (layout)
- SOT223 (layout)
- SOT223V2 (layout)
- SOT323 (layout)
- SRP (layout)
- TO39 (layout)
- TO72 (layout)
- TO72V2 (layout)
- TO92 (layout)
- TO117 (layout)
- TO206AA (layout)
- TO206AF (layout)
- TO226AA (layout)
- TPLAST (layout)
- TUNCAP (layout)
- UMD (layout)
- UPRIGHT (layout)
- URP (layout)
- WIRE0 (layout)
- WIRE1 (layout)

1D2J1A

1-2J1A
 2 ports
 package 59 × 110.2 mil
 2 leads 23.6 × 255.9 mil
 2 pads 43.6 mil square
 Diode

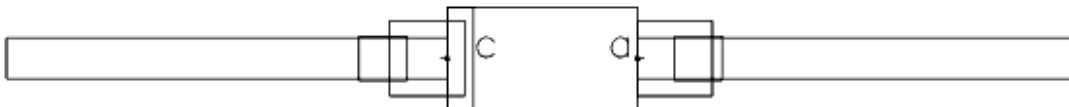

NOTE: text size for a and c has been enlarged

2D3H1A

2-3H1A
 3 ports
 flange 98.4 × 338.6 mil
 package 98.4 mil square and circle 90 mil diameter

holes 63 mil diameter 240.2 mil center-to-center
 2 leads 23.6 × 78.8 mil
 2 pads 23.6 mil square
 FET

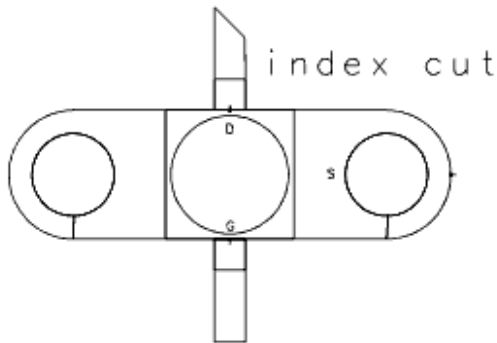

2D3J1C

2-3J1C
 4 ports
 SMT
 package 114.4 × 59 mil
 2 short leads 15.8 × 21.8 mil, 1 long lead 15.8 × 33.6 mil
 collector lead 23.6 × 53.6 mil
 pads are lead size plus 10 mil
 BJT

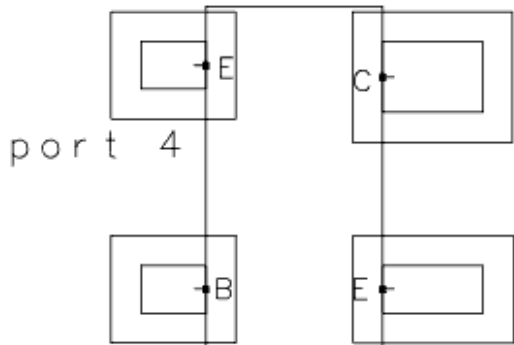

2D7C1A

2-7C1A
 3 ports
 flange 236.2 × 728.4 mil
 package 236.2 × 267.8 mil and 220.4 × 267.8 mil
 holes 98.4 mil diameter spaced 551.2 mil center-to-center
 2 leads 27.6 × 157.5 mil
 2 pads 27.6 mil square
 FET

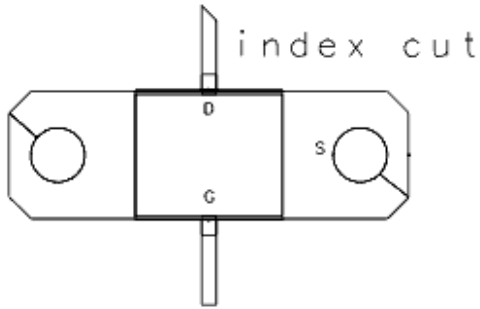

145MILXP

145 MIL X-PACK

4 ports

package and hole 145 mil diameter

3 leads 30 × 155.5 mil, 1 lead 30 × 391.5 mil

pads 60 mil square

BJT

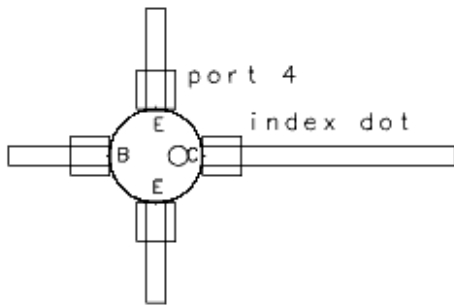

145ML4PK

145 MIL FOUR-PACK

4 ports

package and hole 145 mil diameter

4 leads 30 × 168.7 mil

pads 60 mil square

BJT

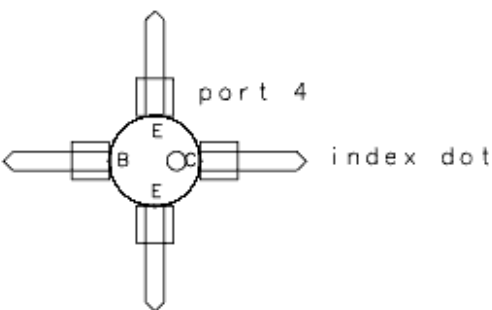

AFLANGE

(no name given by vendor)

3 ports

flange 820 × 250 mil

holes 120 mil diameter spaced 570 mil center-to-center

leads 50 × 150 mil

pads 50 mil square

FET

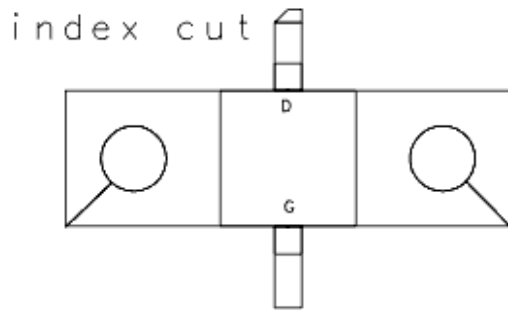

AK

AK

5 ports

open flange 976 × 256 mil

holes 130 mil diameter spaced 726 mil center-to-center

leads 60 × 205 mil

pads 60 mil square

FET

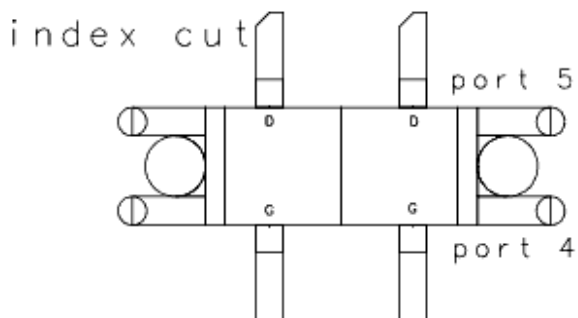

ALMK

Alignment marker

conductor diameter 30 mil

no ports

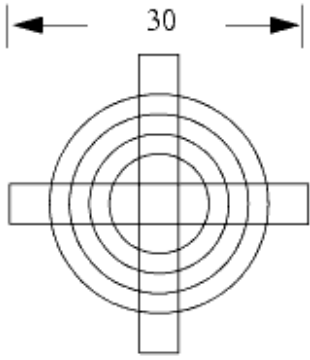

ALMK2

Alignment marker
conductor diameter 20 mil
no ports

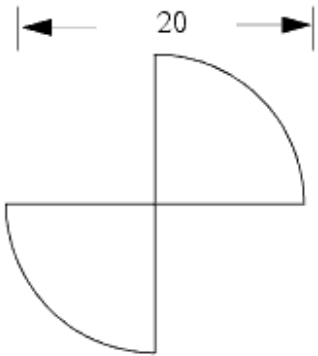

AP

AP
3 ports
flange 750 × 250 mil
holes 125 mil diameter 560 mil center-to-center
leads 60 × 200 mil
pads 60 mil square
FET

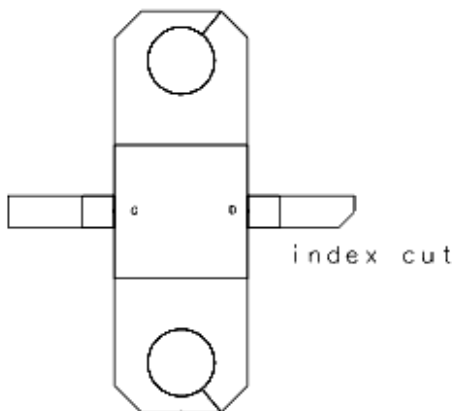

AQ

AQ
 5 ports
 flange 750 × 250 mil
 holes 130 mil diameter 560 mil center-to-center
 leads 60 × 197.5 mil
 pads 60 mil square
 FET

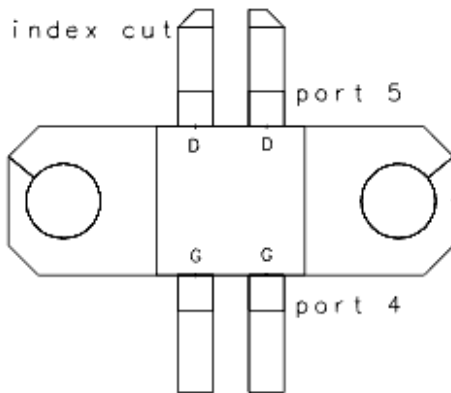

ATCCAP

Chip capacitor outline
 2 ports
 75 mil port-to-port
 leads 110 × 25 mil
 packages 110 × 75

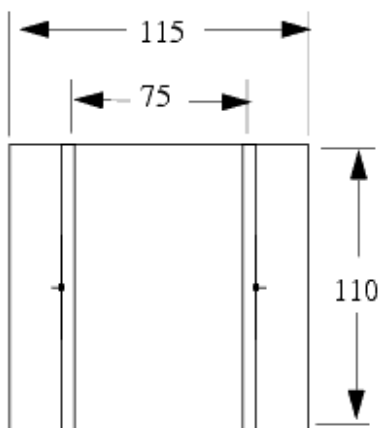

ATF36

Avantek 36
 4 ports

SMT
 package 100 mil octagon and 83 mil diameter circle
 leads 20 × 40 mil
 pads 20 mil square
 FET

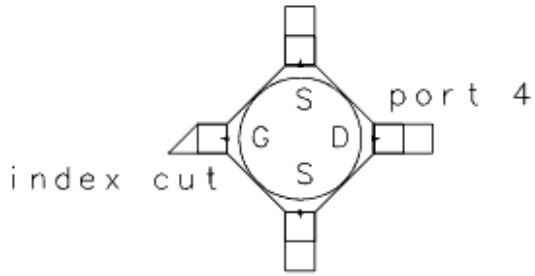

ATF70

Avantek 70
 4 port
 SMT
 package 70 mil square and circle
 2 leads 40 × 212.5 mil, 2 leads 20 × 212.5 mil
 2 pads 40 mil square, 2 pads 20 mil square
 FET

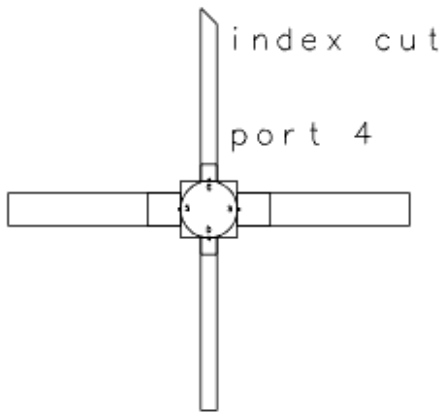

ATF76

Avantek 76
 4 ports
 SMT
 package 70 mil octagon and circle
 2 leads 40 × 69 mil, 2 leads 20 × 69 mil
 2 pads 40 mil square, 2 pads 20 mil square
 FET

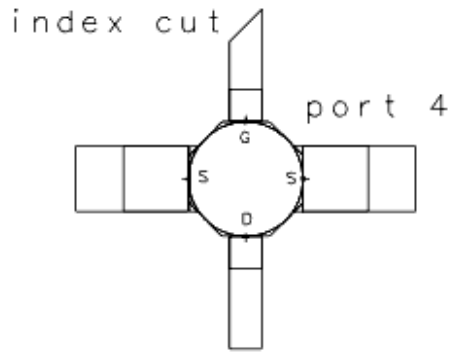

ATF84

Avantek 84
 4 ports
 package 85 mil diameter
 hole 85 mil diameter
 leads 20 × 65 mil
 pads 20 × 20 mil
 FET

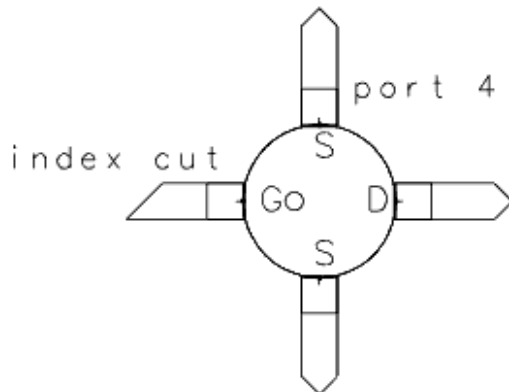

ATF86

Avantek 86
 4 ports
 SMT
 package 85 mil diameter
 leads 20 × 57.5 mil
 pads 40 × 66.3 mil
 FET

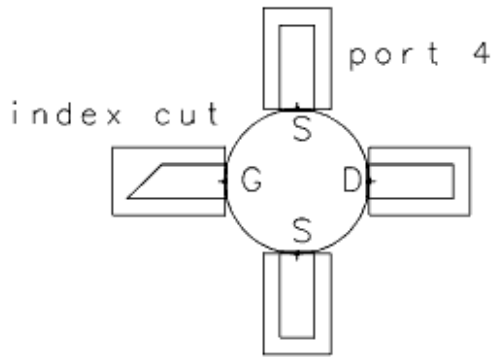

AVNK35

Avantek 35
4 ports
SMT
package 100 mil square
leads 20 × 175 mil
pads 40 mil square
BJT

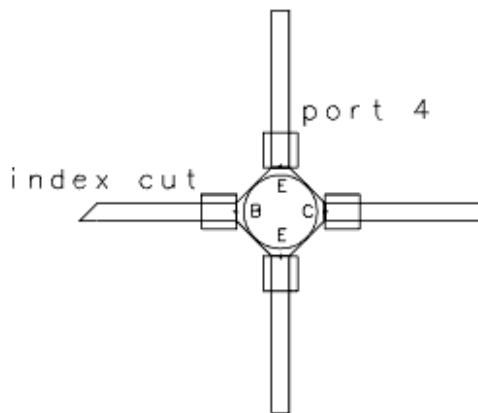

AVNK70

Avantek 70
4 ports
SMT
package 70 mil square and circle
leads 40 × 212.5 mil and leads 20 × 212.5 mil
pads 40 mil square and pads 20 mil square
BJT

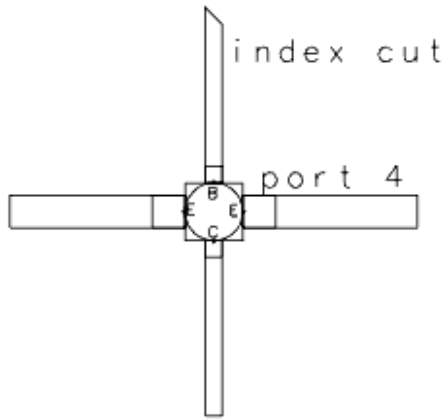

AVNK85

Avantek 85
4 ports
package and hole 85 mil diameter
leads 20 × 207.5 mil
pads 40 mil square
BJT

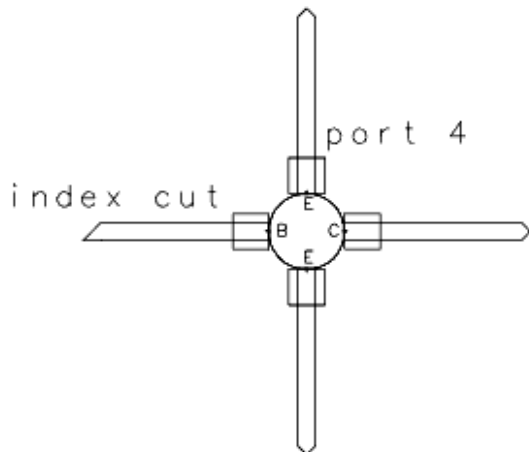

AVNK86

Avantek 86
4 ports
SMT
package 85 mil diameter
leads 20 × 57.5 mil
pads 40 × 66.3 mil
BJT

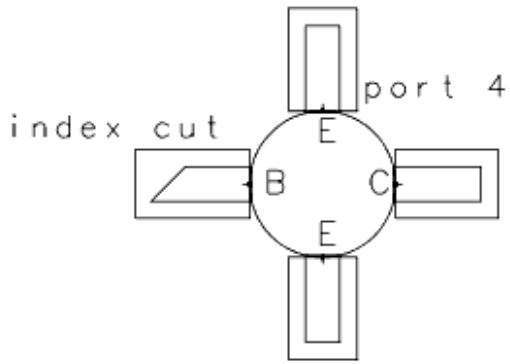

AXIAL_L

Axial leaded components (large)
 2 ports
 leads 30 × 325
 packages 300 × 770

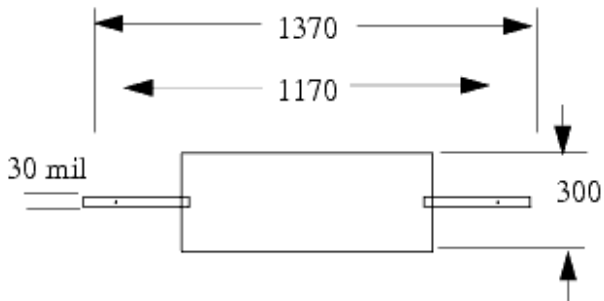

AXIAL_M

Axial leaded components (medium)
 2 ports
 leads 30 × 270
 packages 140 × 390

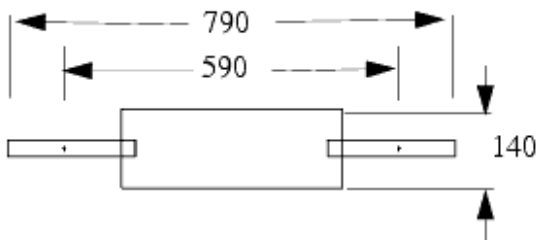

AXRES

Axial leaded components (small)
 2 ports
 leads 29 × 100 mil

resistor 95 × 249

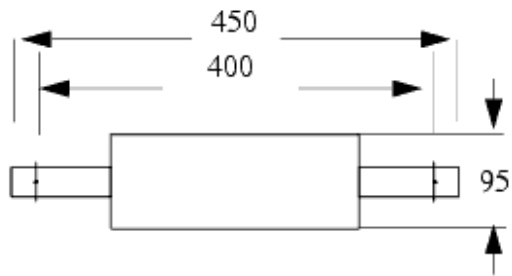

AXRES2

Axial leaded components

2 ports

leads 17.5 × 60 mil

resistor 57 × 150

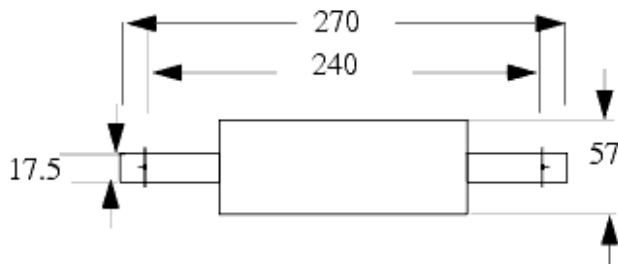

AXRES3

Axial leaded components

2 ports, 500 mil port-to-port

leads 29.2 × 205 mil

resistor

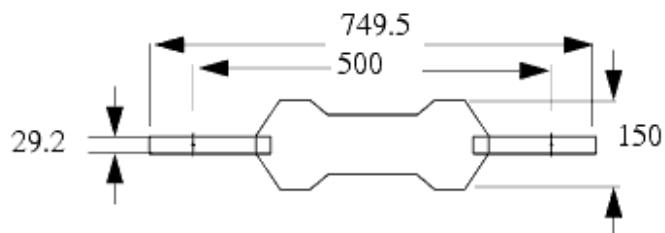

BFLANGE

no name given by vendor

3 ports

flange 820 × 250 mil

holes 120 mil diameter 570 mil center-to-center

leads 50 × 170 mil

pads 50 mil square

FET

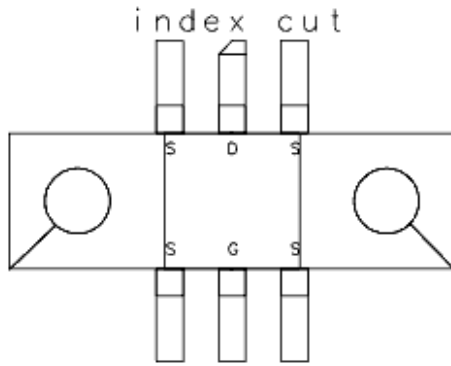

C145D01

Motorola Case 145-01

4 ports

stud mount

package 375 mil diameter

hole 325 mil diameter

4 leads 225 × 317.5 mil

3 pads 225 mil square. 1 pad 225 × 205 mil

BJT

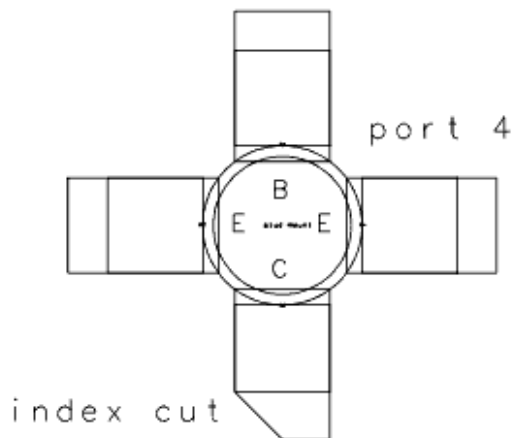

C211D07

Motorola Case 211-07

4 ports

flange 975 × 250 mil

package 380 mil diameter

holes 120 mil diameter 725 mil center-to-center

leads 220 × 210 mil at 45°

pads 220 × 210 mil

FET

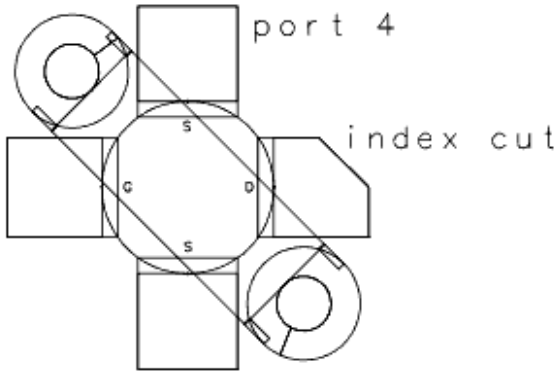

C211D07V2

Motorola Case 211-07

4 ports

flange 975 × 250 mil

package 380 mil diameter

holes 120 mil diameter 725 mil center-to-center

leads 220 × 210 mil at 45°

pads 220 × 210 mil

BJT

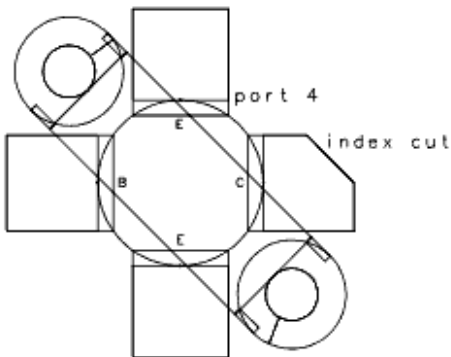

C221CD02

Motorola Case 221C-02

3 ports

drawn as if flange

package 398 × 698 mil

hole 145 mil diameter

3 leads 132 × 33 mil and 58 mil

3 pads 58 × 132 mil

BJT

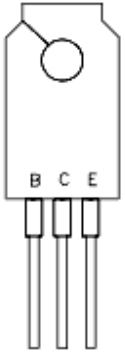

C244D04

Motorola Case 244-04
 4 ports
 stud mount
 package 282 mil diameter
 hole 250 mil diameter
 leads 220 × 294 mil
 pads 220 × 220 mil
 FET

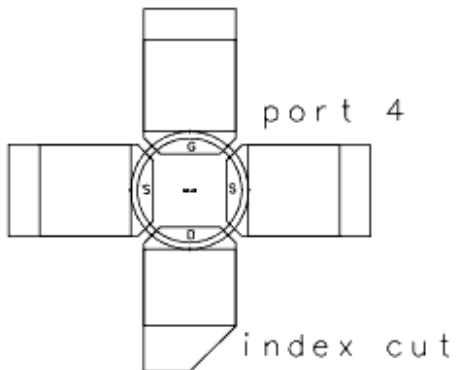

C249D05

Motorola Case 249-05
 4 ports
 package and hole 282 mil diameter
 4 leads 220 × 294 mil
 4 pads 220 mil square
 BJT

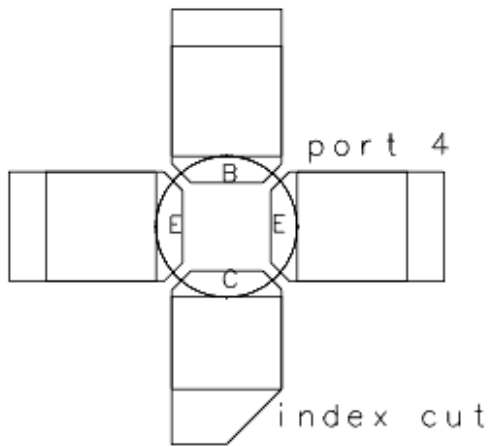

C305D01

Motorola Case 305-01

4 ports

stud mount

package and hole 210 mil diameter

2 leads 60 × 330 mil, 2 leads 30 × 330 mil

2 pads 60 mil square, 2 pads 30 mil square

BJT

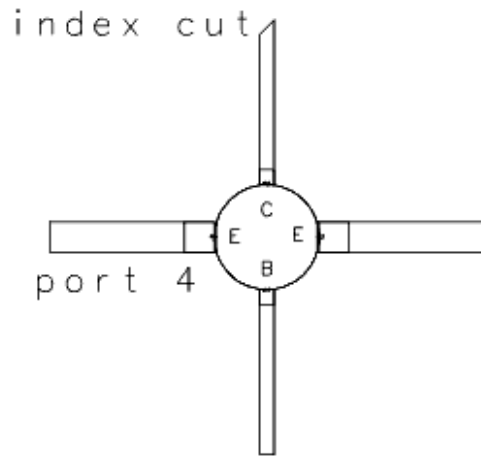

C317D02

Motorola Case 317-02

4 ports

190 mil diameter package and hole

1 lead 100 × 270.5 mil, 3 leads 36 × 207.5 mil

1 pad 100 mil square, 3 pads 72 mil square

BJT

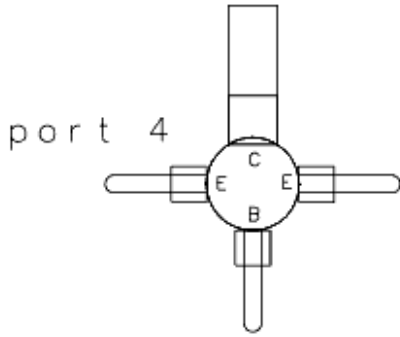

C319BD01

Motorola Case 319B-01

5 ports

flange 975 × 233 mil

holes 130 mil diameter 725 mil center-to-center

leads 60 × 130 mil

pads 60 mil square

FET

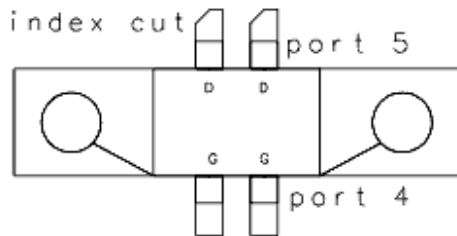

C319D06

Motorola Case 319-06

3 ports

flange 975 × 233 mil

holes 130 mil diameter 725 mil center-to-center

4 leads 60 × 100 mil, 2 leads 120 × 100 mil (one notch)

4 pads 80 × 100 mil, 1 pad 40 × 120 mil

BJT

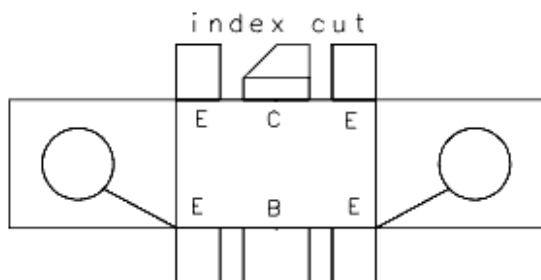

C369D03

Motorola Case 369-03

3 ports

drawn as for flange mount

package 240 × 258 mil

3 leads 30 × 365 mil

2 pads 63 × 118 mil, 1 pad 265 mil square

BJT

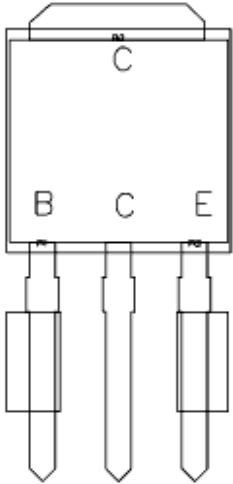

C744AD01

Motorola Case 744A-01

8 ports

flange 385 × 900 mil

package 424 × 400 mil

holes 126 mil diameter 650 mil center-to-center

4 leads 182 × 70 mil, 4 leads 182 × 120 mil

4 pads 70 mil square, 4 pads 120 mil square

BJT

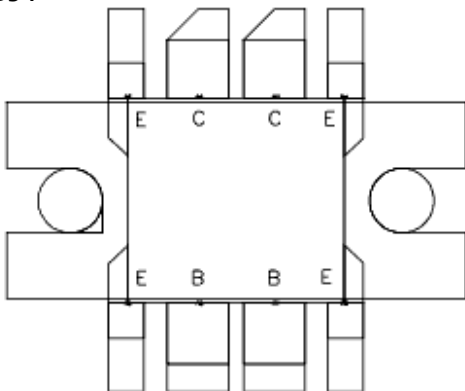

C751D03

Motorola Case 751-03

8 ports

SMT

single device inside
 package 192×154 mil
 8 leads 16.5×41.5 mil
 8 pads 36.5 mil square
 BJT

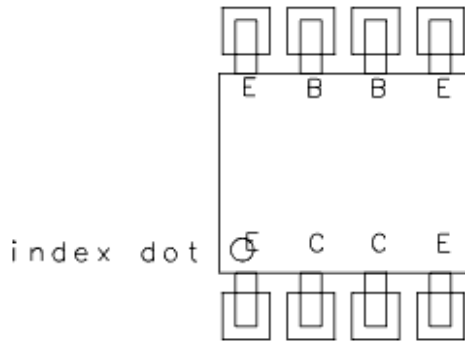

C2003

Motorola Case 20-03
 3 ports
 case 219.5 mil diameter
 holes 21 mil diameter 50 mil from case center
 pads 40 mil square
 BJT

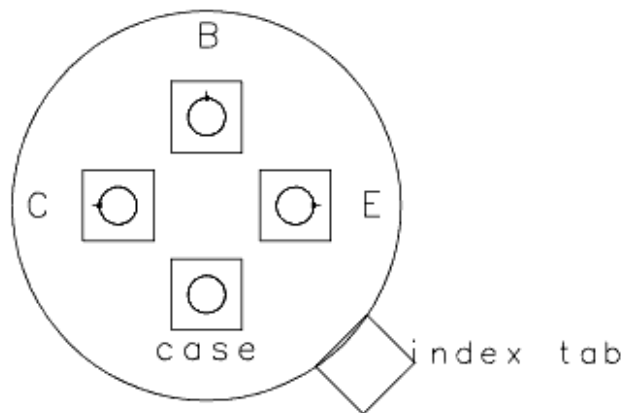

C2904

Motorola Case 29-04
 3 ports
 package 170 mil diameter cut \times 135 mil chord
 holes 22 mil diameter and 22×20 mil
 pads 40 mil square
 Diode

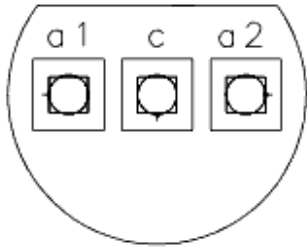

C5102

Motorola Case 51-02

2 ports

package 96 × 265 mil

2 leads 20 × 40 mil (bent)

2 holes 22 mil square

2 pads 44 mil square

Diode



C7904

Motorola Case 79-04

3 ports

package 352.5 mil diameter

holes 21 mil diameter

100 mil from package center

pads 40 mil square

BJT

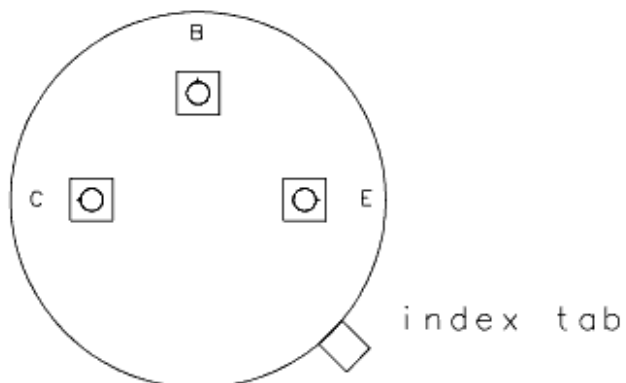

C18202

Motorola Case 182-02

2 ports
 package 170 mil diameter cut × 130 mil chord
 holes 22 mil diameter and 22 × 20 mil
 pads 40 mil square
 Diode

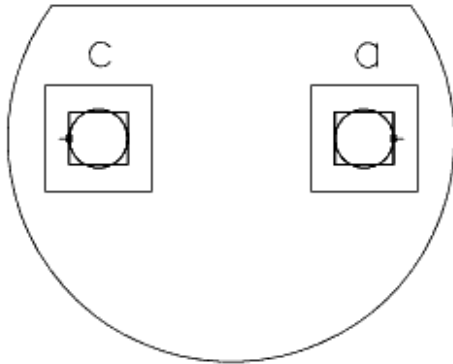

C30301

Motorola Case 303-01
 4 ports
 SMT
 100 mil square package
 2 leads 40 × 197.5 mil, 2 leads 20 × 197.5 mil
 pads 40 mil square
 BJT

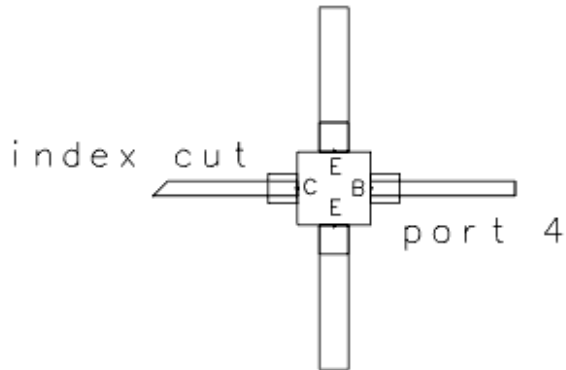

CD

CD
 4 ports
 package 250 mil square
 2 leads 100 × 200 mil, 1 lead 90 × 200 mil, 1 lead 50 × 200 mil
 2 pads 100 mil square, 1 pad 90 mil square, 1 pad 50 mil square
 FET

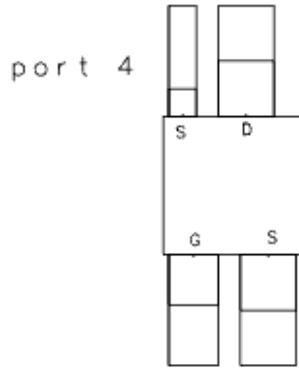

CERECX

CEREC-X

4 ports

SMT

package 100.4 mil octagon and 86.6 mil diameter circle

leads 19.7 × 32.5 mil

pads 39.5 mil square

BJT

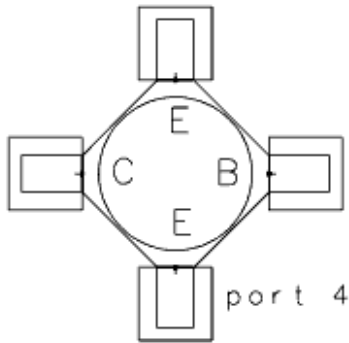

CERECXF

CEREC-XF

4 ports

SMT

package 70 mil octagon

leads 20 × 47.5 mil

pads 20 mil square

FET

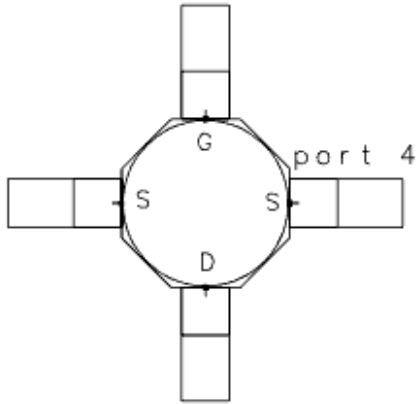

CHPCAP

Surface mount components
 conductor 40 × 30 mil
 packages 60 × 120 mil
 2 ports

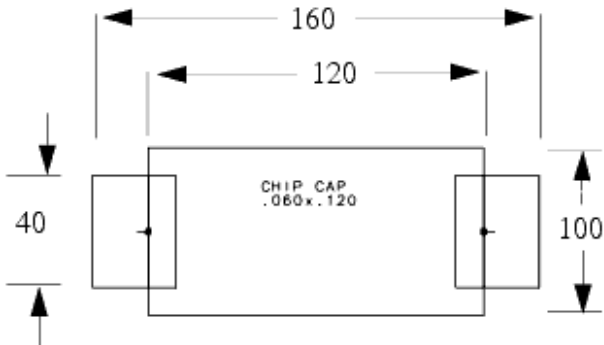

CHPRES

2 ports
 packages 60 × 120 mil
 leads 40 × 30 mil



C-LL

Alignment corner marks
 no ports
 conductor 5 mil wide

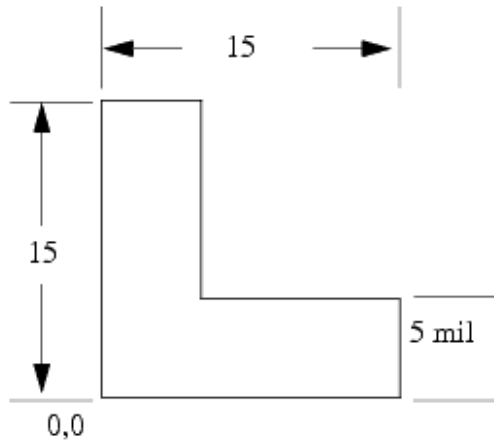

C-LR

Alignment corner marks
no ports
conductor 5 mil wide

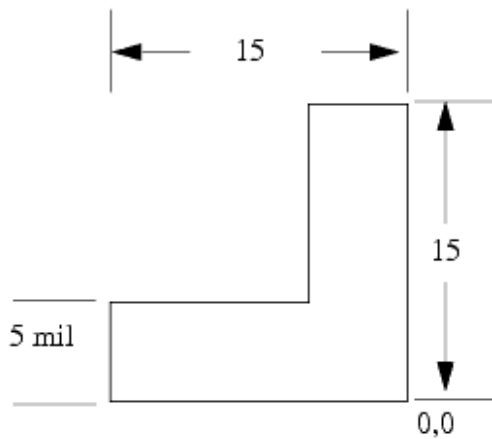

COIL1

General inductor outline
hand wound coil inductor
2 ports
dia.35 mil

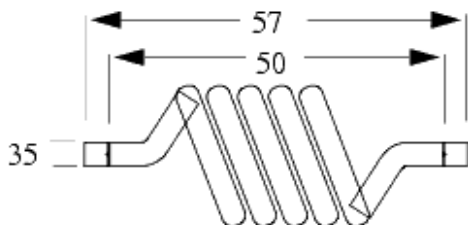

C-UL

Alignment corner marks
no ports
conductor 5 mil wide

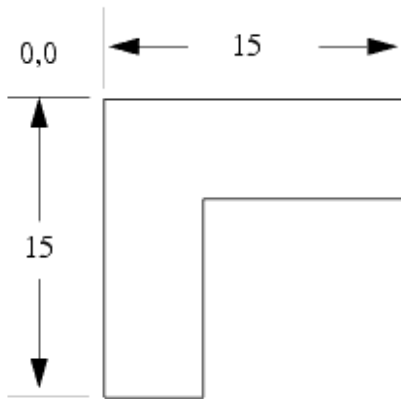

C-UR

Alignment corner marks
no ports
conductor 5 mil wide

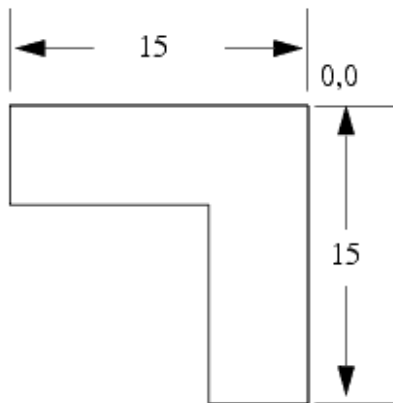

DISK_L

Ceramic disk capacitors (large)
2 ports 200 mil port-to-port
packages 140 × 432 mil
leads 24 mil diameter

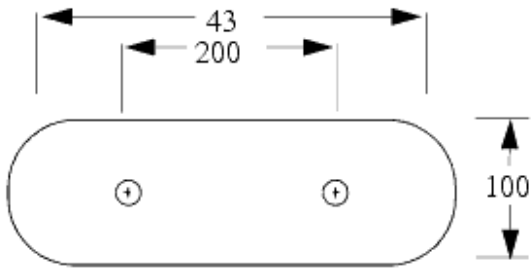

DISK_M

Ceramic disk capacitors (medium)
 2 ports 200 mil port-to-port
 packages 140 × 300 mil
 leads 24 mil diameter

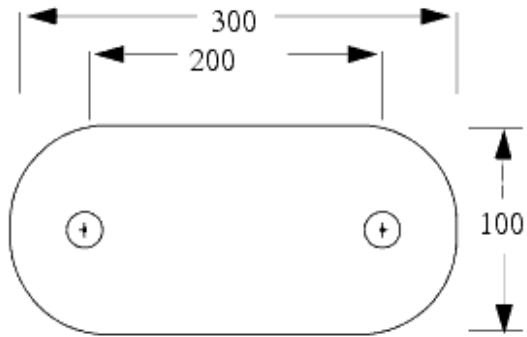

DISK_S

Ceramic disk capacitors (small)
 2 ports 90 mil port-to-port
 packages 140 × 200 mil
 leads 24 mil diameter

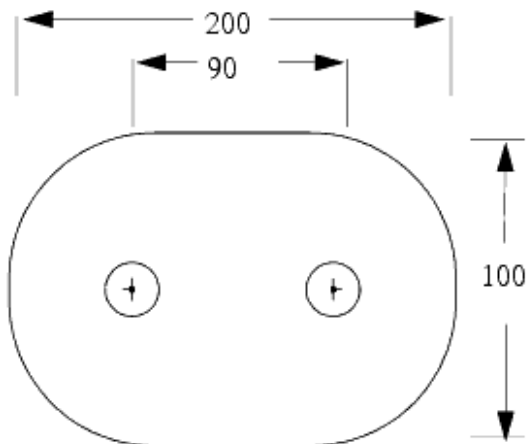

GD4

GD4

4 ports

SMT

package 75 mil octagon

2 leads 40 × 157.5 mil, 2 leads 20 × 157.5 mil

2 pads 40 mil square, 2 pads 20 mil square

FET

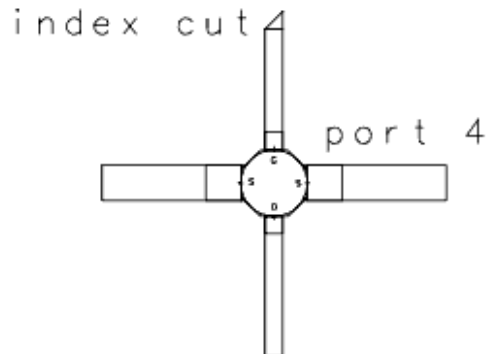

GD7

GD7

4 ports

SMT

package 70 mil square (package is octagonal underneath)

2 leads 40 × 30 mil, 2 leads 20 × 30 mil

2 pads 40 mil square, 2 pads 20 mil square

FET

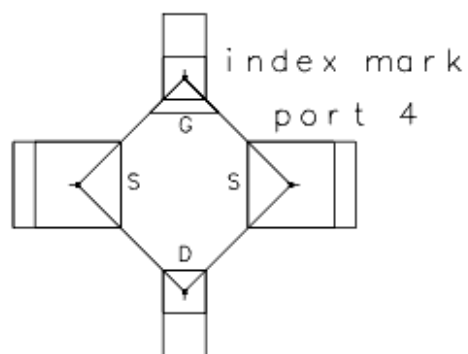

GD9

GD9

4 ports

SMT

package 70 mil square

2 leads 40 × 157.5 mil, 2 leads 20 × 157.5 mil

2 pads 40 mil square, 2 pads 20 mil square

FET

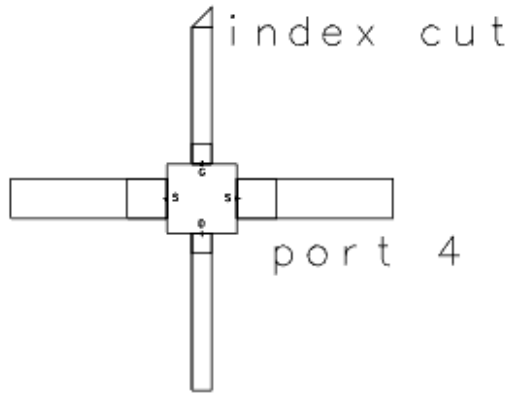

GD11

GD11
 4 ports
 SMT
 package 98.4 mil square and circle
 2 leads 39.4 × 196.9 mil, 2 leads 19.7 × 196.9 mil
 2 pads 39.4 mil square, 2 pads 19.7 mil square
 FET

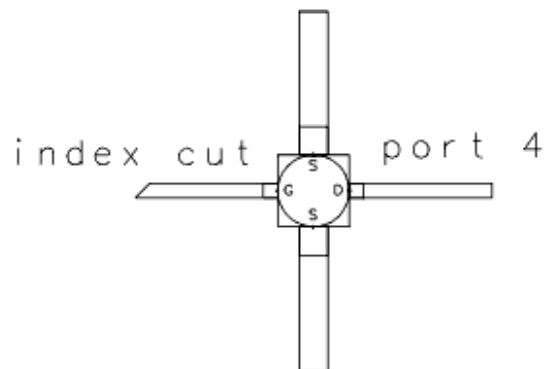

GD16

GD16
 4 ports
 SMT
 package 75 mil octagon
 2 leads 40 × 40 mil, 2 leads 20 × 40 mil
 2 pads 40 mil square, 2 pads 20 mil square
 FET

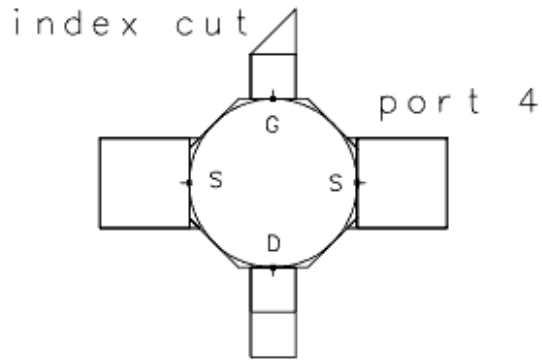

GF1

GF1
 3 ports
 flange 327 × 98 mil 10 mil rad corners
 package 98 mil square
 2 holes 63 mil diameter 213 mil center-to-center
 2 leads 24 × 79 mil
 2 pads 24 mil square
 FET

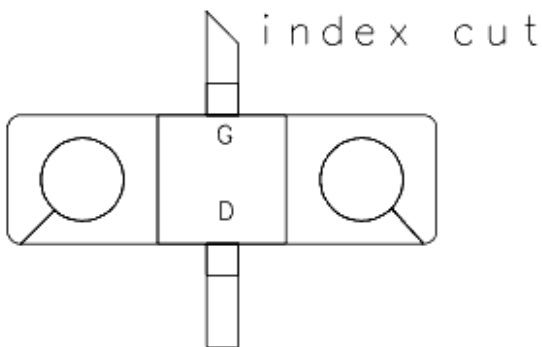

GF4

GF4
 3 ports
 flange 417 × 138 mil 12 mil corners
 package 150 × 98 mil minus indentations
 holes 63 mil diameter 264 mil center-to-center
 2 leads 24 × 79 mil
 2 pads 24 mil square
 FET

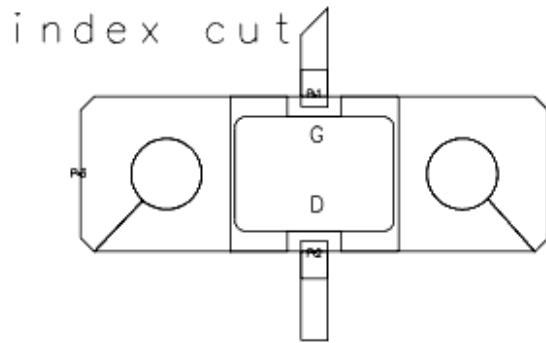

GF7

GF7
 3 ports
 flange 551 × 173 mil
 package 197 × 173 mil minus indentations
 holes 87 mil diameter 354 mil center-to-center
 2 leads 24 × 79 mil
 2 pads 24 mil square
 FET

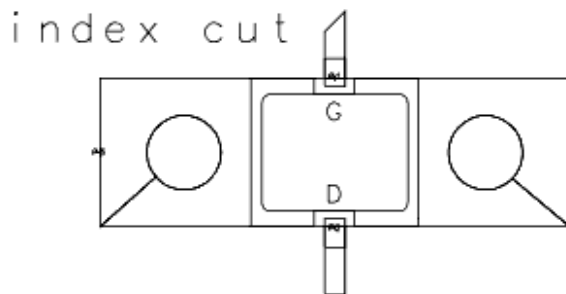

GF11

GF11
 3 ports
 open flange 433 × 256 mil
 holes 70 mil diameter 362 mil center-to-center
 2 leads 20 × 79 mil
 2 pads 20 mil square
 FET

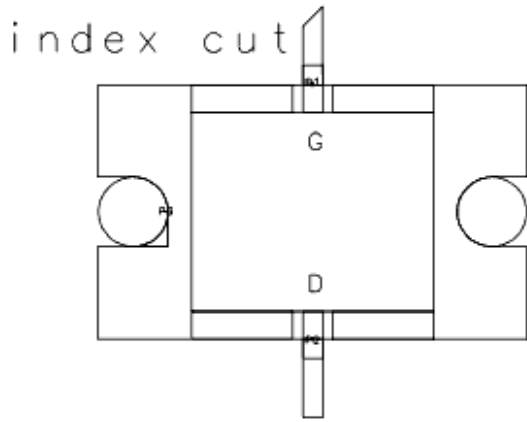

GF21

GF21
 3 ports
 open flange 689 × 250 mil 30 mil corners
 holes 98.4 mil diameter 563 mil center-to-center
 2 leads 39.4 × 157.5 mil
 2 pads 39.4 × 39.4 mil
 FET

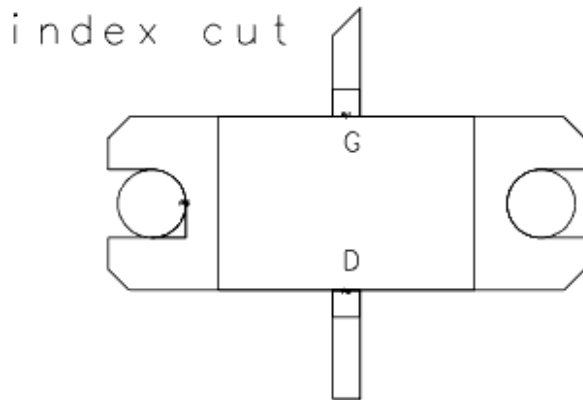

HP70GT

HPAC-70GT
 4 ports
 SMT
 package 70 mil diameter
 2 leads 30 × 165 mil, 2 leads 20 × 165 mil
 pads 40 mil square
 BJT

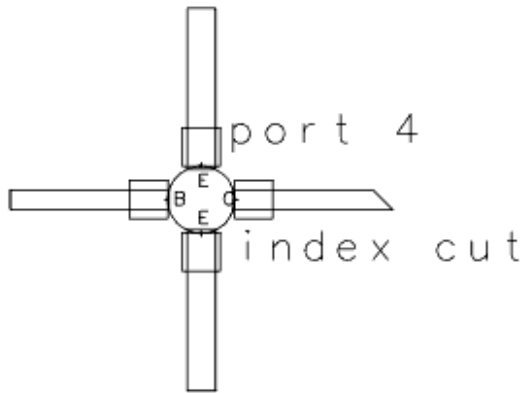

HP85PLAS

HP85 Plastic
 4 ports
 package and hole 85 mil diameter
 leads 20 × 100.5 mil
 pads 40 mil square
 BJT

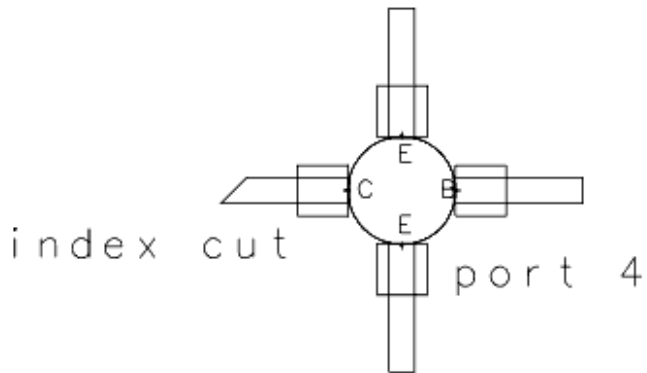

HPAC100

HPAC100
 4 ports
 SMT
 package 100 mil square and diameter
 2 leads 40 × 130 mil, 2 leads 20 × 130 mil
 pads 40 mil square
 BJT

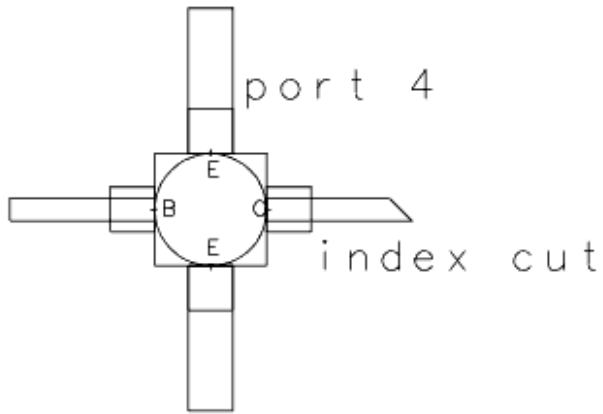

HPAC100X

HPAC100X

4 ports

SMT

package 100 mil octagon and 83 mil diameter circle

4 leads 20 × 150 mil

pads 40 mil square

BJT

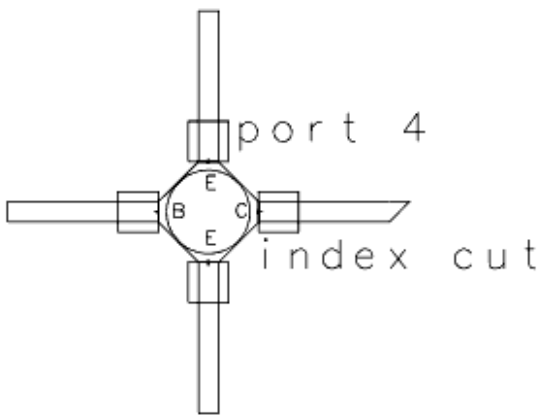

HPAC200

HPAC200

4 ports

package and hole 200 mil diameter

leads enter package at 128 mil diameter

2 leads 60 × 200 mil, 2 leads 30 × 200 mil

pads 60 mil square

BJT

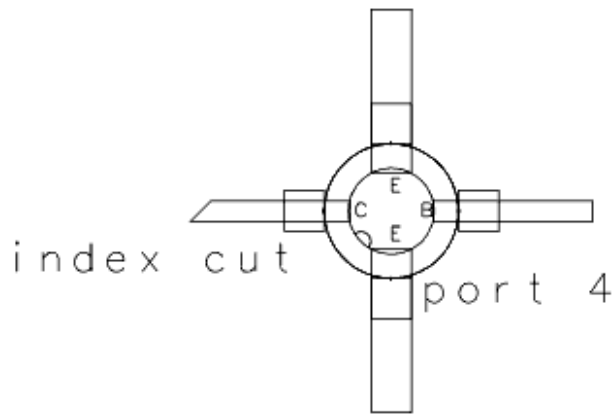

HPAC200V2

HPAC200

4 ports

package and hole 200 mil diameter

leads enter package at 128 mil diameter

2 leads 60 × 200 mil, 2 leads 30 × 200 mil

pads 60 mil square

BJT

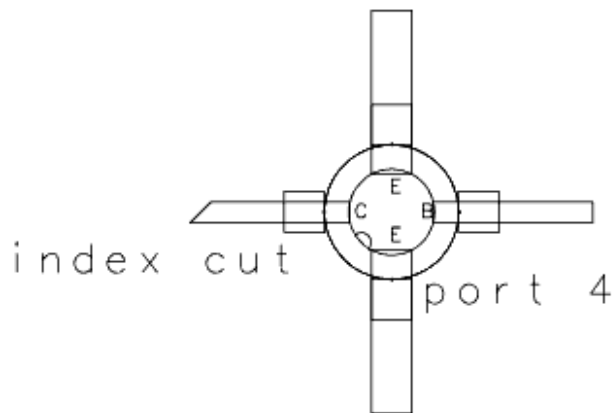

LG

LG

4 ports

SMT

package 70 mil octagon

2 leads 40 × 59 mil, 2 leads 20 × 59 mil

2 pads 40 mil square, 2 pads 20 mil square

FET

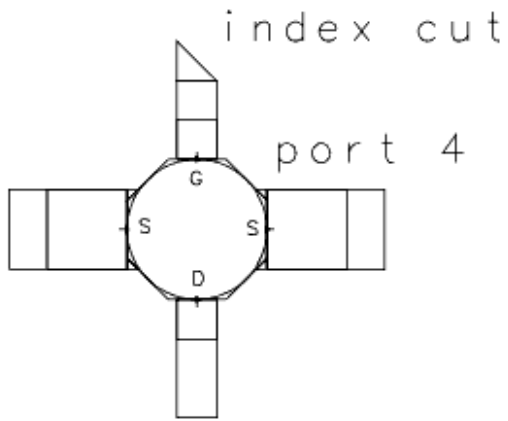

LLD

LLD
2 ports
SMT
package 114.2×53.2 mil
2 leads 11.8×53.2 mil
2 pads 31.8×73.2 mil
Diode



M205

M205
2 ports
SMT
package 60×106.3 mil
2 leads 21.7×21.5 mil
2 pads 41.7×41.5 mil
Diode

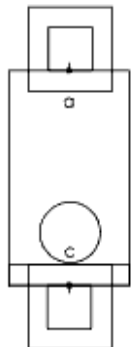

M253

M253
 4 ports
 SMT
 package 70 mil octagon
 2 leads 40 × 59 mil, 2 leads 20 × 59 mil
 2 pads 40 mil square, 2 pads 20 mil square
 FET

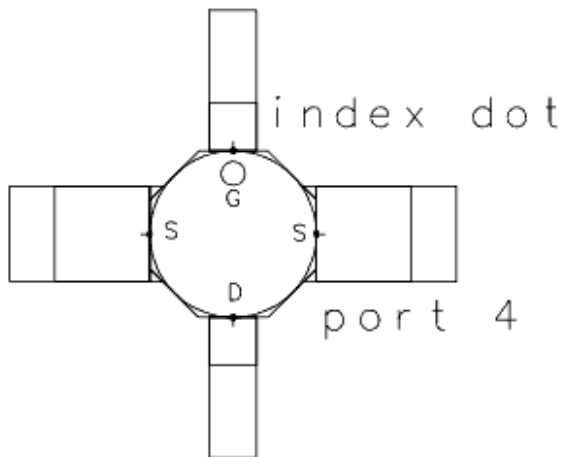

MACROT

MACRO-T
 3 ports
 package and hole 190 mil diameter
 2 pins 36 × 207.5 mil, 1 pin 36 × 337.5 mil
 pads 72 mil square
 BJT

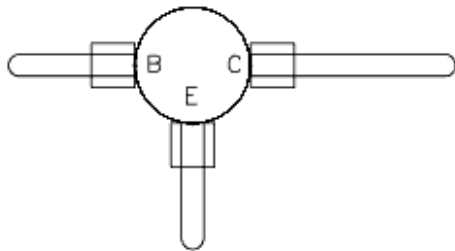

MACROX

MACRO-X
 4 ports
 package and hole 190 mil diameter
 3 pins 36 × 207.5 mil, 1 pin 36 × 337.5 mil
 pads 72 mil square
 BJT

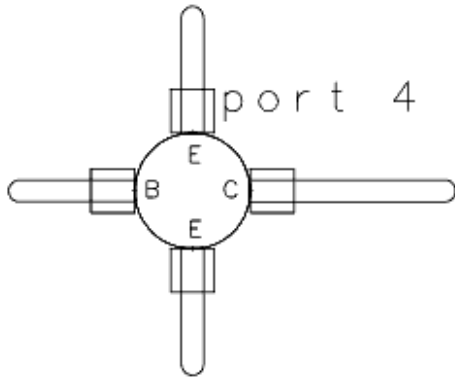

ME

ME
3 ports
flange 630 × 197 mil
package 197 mil square
holes 87 mil diameter 472 mil center-to-center
2 leads 39 × 79 mil
2 pads 39 mil square
FET

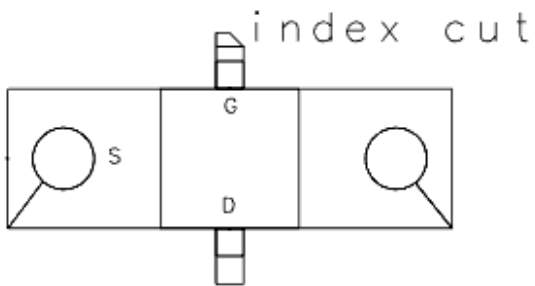

MICROX

MICRO-X
4 ports
SMT
package 100 mil octagon and 83 mil diameter circle
leads 20 × 177.5 mil
pads 40 mil square
BJT

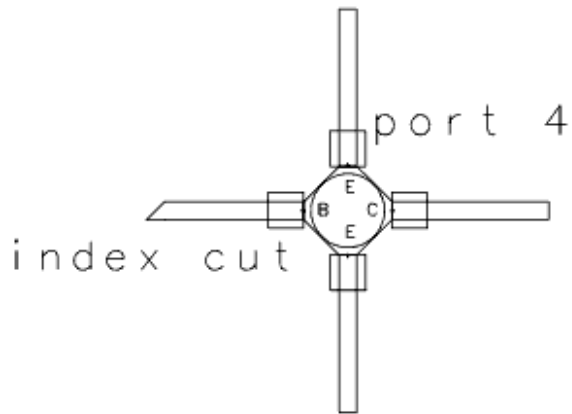

MOP

Mini Octal Package

8 ports

SMT

package 185.4×59 mil

8 leads 25×15.8 mil

8 pads 45×35.8 mil

Diode

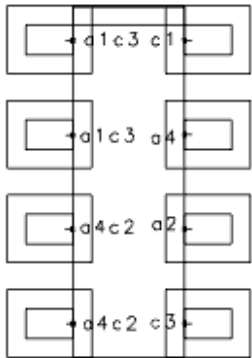

MW4

MW4

4 ports

SMT

package 51.2×114.2 mil

2 leads 31.5×25.6 mil, 2 leads 15.8×25.6 mil

2 pads 51.5×45.6 mil, 2 pads 35.8×45.6 mil

FET

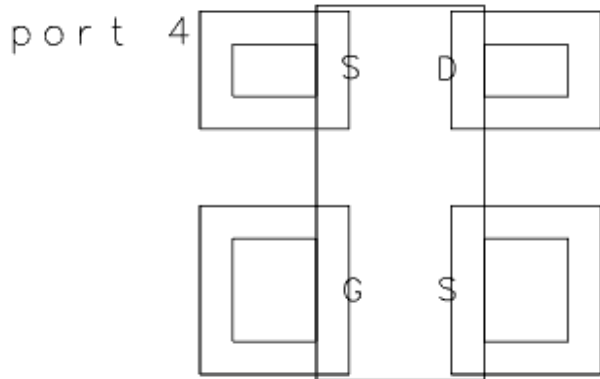

MWT70

MWT70

4 ports

SMT

package 70 mil square and circle

2 leads 40 × 200 mil, 2 leads 20 × 200 mil

2 pads 40 mil square, 2 pads 20 mil square

FET

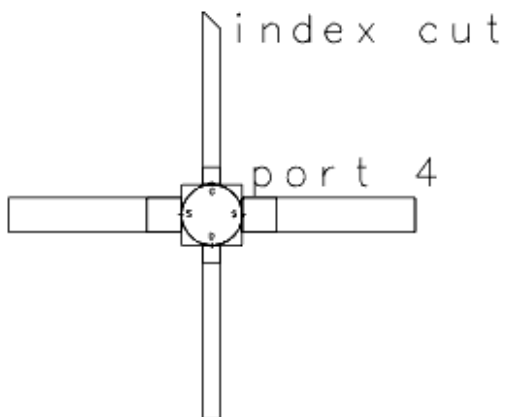

MWT71

MWT71

3 ports

flange 335 × 98 mil

package 98 mil square

holes 63 mil diameter 240 mil center-to-center

2 leads 24 × 201 mil

2 pads 24 mil square

FET

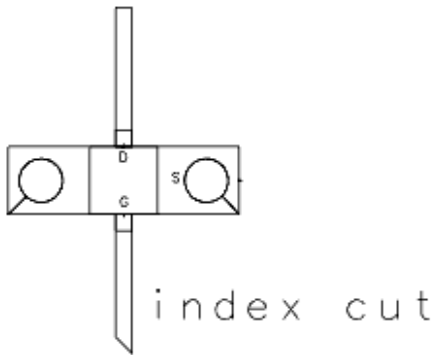

MWT73

MWT73

4 ports

SMT

package 70 mil octagon and circle

2 leads 40 × 157 mil, 2 leads 20 × 157 mil

2 pads 40 mil square, 2 pads 20 mil square

FET

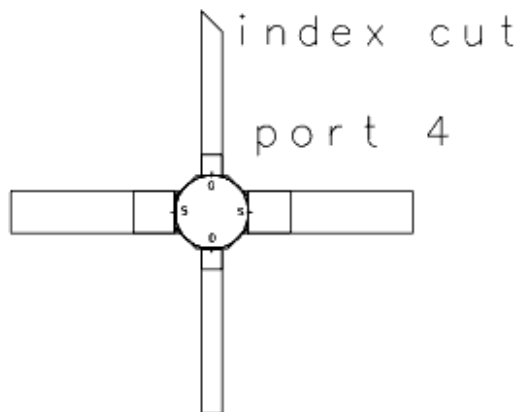

NEC01

NEC01

3 ports

package 275.6 mil diameter circle cut to 244 mil width

1 lead 59 × 78.8 mil, 1 lead 59 mil square

1 pad 59 mil square, 1 pad 59 × 78.8 mil

emitter on bottom

BJT

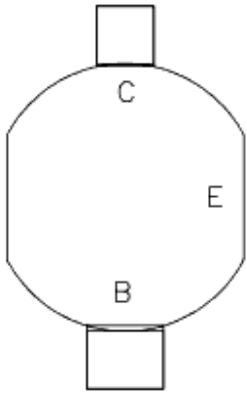

NEC03

NEC03

4 ports

SMT

package 137.8 mil diameter

2 leads 78.7×196.9 mil, 2 leads 39.4×196.9 mil

pads 78.7 mil square

BJT

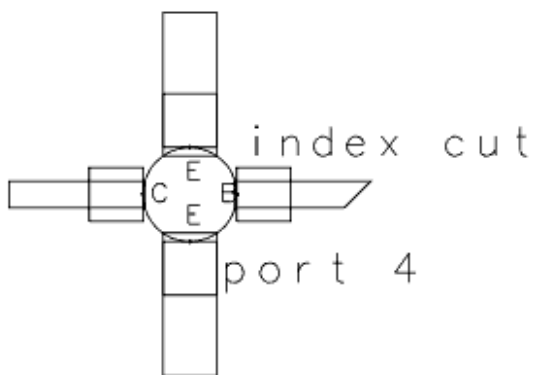

NEC07

NEC07

4 ports

SMT

package 98.4 mil square and circle

2 leads 39.4×196.9 mil, 2 leads 19.7×196.9 mil

pads 39.4 mil square

BJT

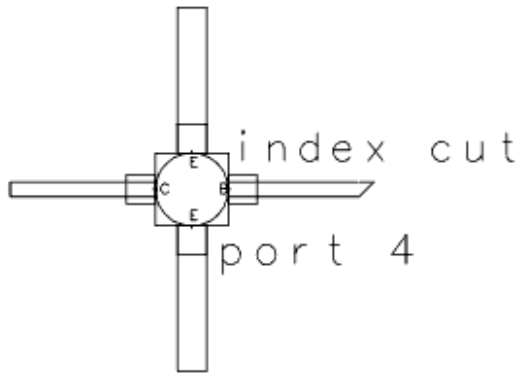

NEC08

NEC08
4 ports
SMT
package 78.7 mil square
leads 23.6 × 196.9 mil
pads 47.2 mil square
BJT

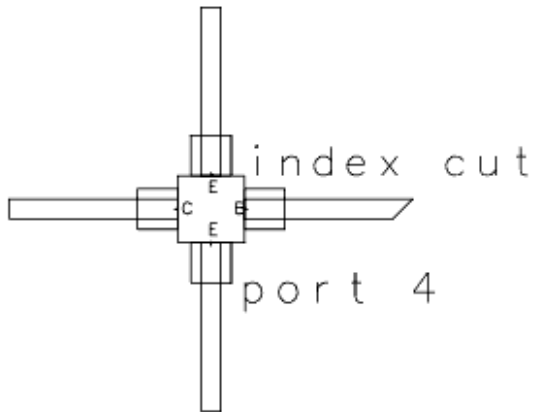

NEC12

NEC12
3 ports
package 229.9 mil diameter
holes 17.8 mil diameter
50 mil from package center
pads 40 mil square
BJT

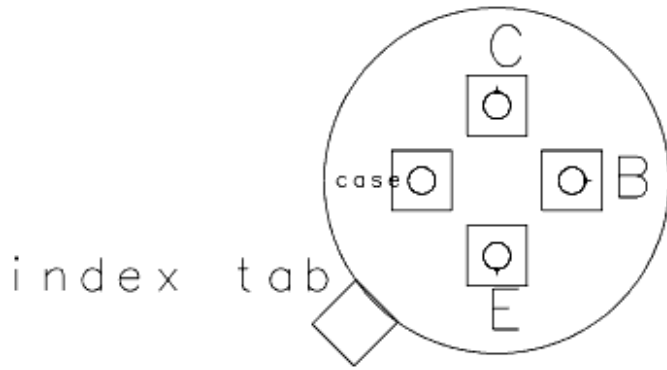

NEC13

NEC13
 3 ports
 package 370.1 mil diameter
 holes 17.8 mil diameter
 100 mil from package center
 pads 40 mil square
 BJT

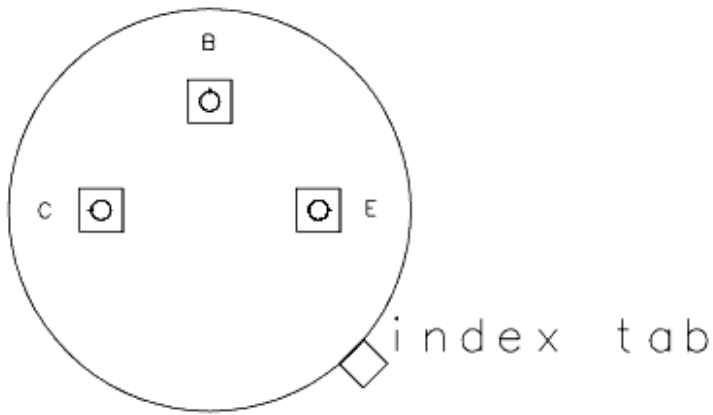

NEC14

NEC14
 3 ports
 package 370.1 mil diameter
 holes 17.8 mil diameter
 100 mil from package center
 pads 40 mil square
 BJT

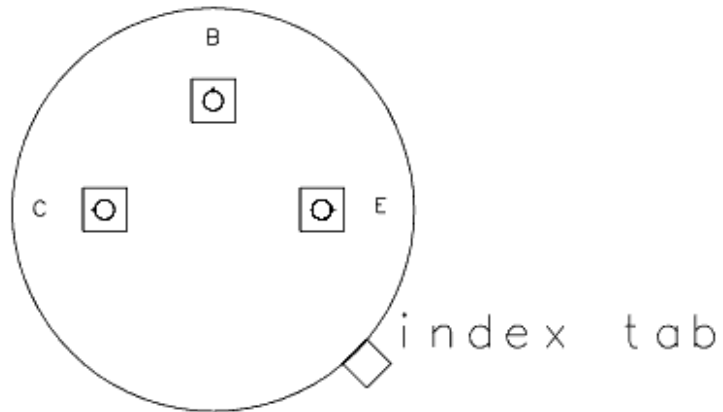

NEC15

NEC15
3 ports
package 370.1 mil diameter
holes 17.8 mil diameter
100 mil from package center
pads 40 mil square
BJT

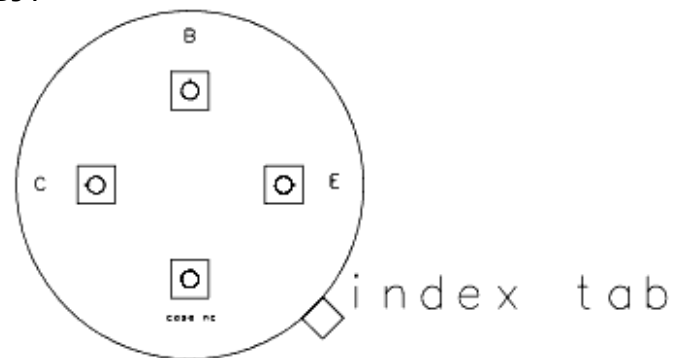

NEC18

NEC18
4 ports
SMT
package 49.2 × 78.7 mil
3 leads 11.8 × 15.8 mil, 1 lead 15.8 mil square
3 pads 31.8 mil square

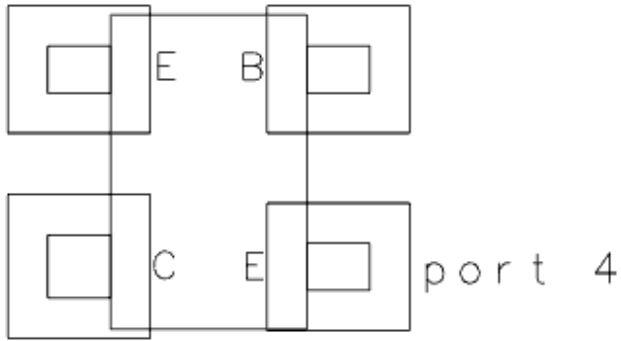

NEC19

NEC19

3 ports

SMT

package 31.5×63 mil

2 leads 7.9×15.8 mil, 1 lead 11.8×15.8 mil

BJT

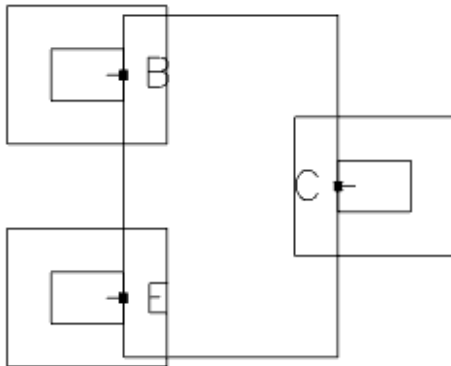

NEC20

NEC20

4 ports

stud mount

package and hole 295.3 mil diameter

4 leads 78.8×196.9 mil

4 pads 78.8 mil square

BJT

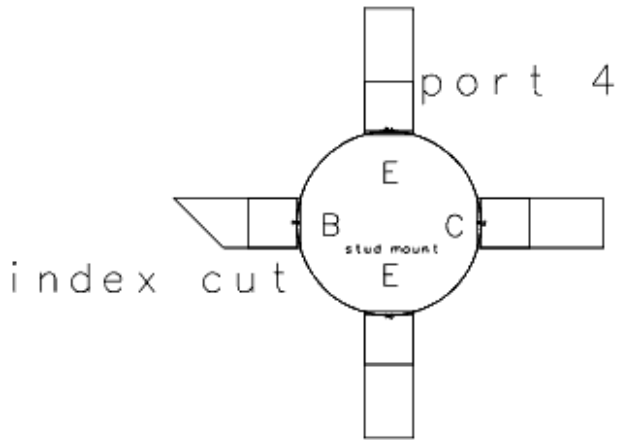

NEC30

NEC30

3 ports

SMT

package 49.3×78.8 mil

leads 11.8×16.7 mil

pads 31.9×36.8 mil

BJT

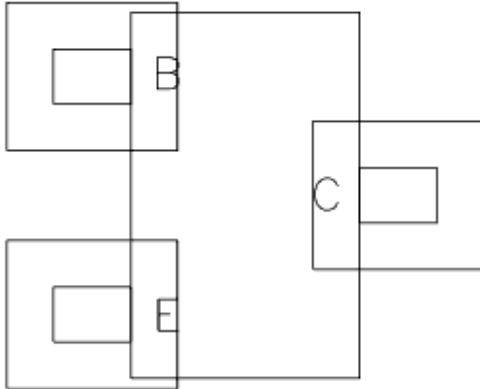

NEC32

NEC32

3 ports

package 204.7 mil diameter circle cut \times 149.9 mil chord

total y-axis height 165.4 mil

holes 19.7 mil diameter 69.7 mil down from chord spaced 50 mil center-to-center

pads 40 mil square

BJT

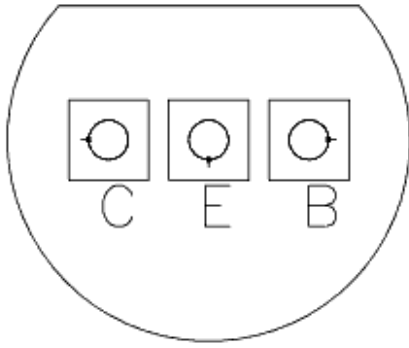

NEC33

NEC33

3 ports

SMT

package 115 × 51 mil

leads 16.5 × 21.5 mil

pads 41.5 × 39.4 mil

BJT

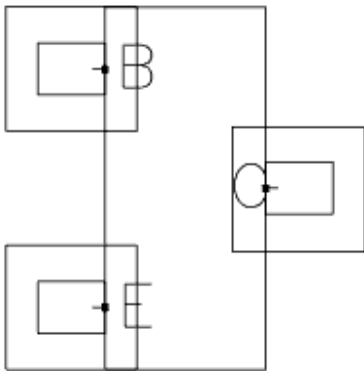

NEC34

NEC34

3 ports

SMT

package 177.2 × 97.7 mil

2 leads 16.5 × 33.1 mil and 27.6 × 64.4 mil

2 pads 39.4 × 59.1 mil

BJT

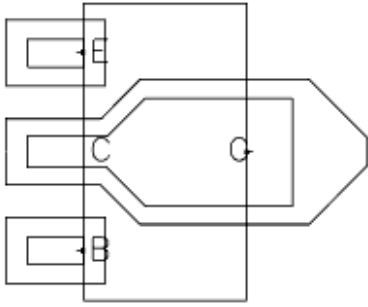

NEC35

NEC35
4 ports
SMT
package 100.4 mil octagon and 82.7 mil diameter circle
leads 19.7 × 149.6 mil
pads 39.4 mil square
BJT

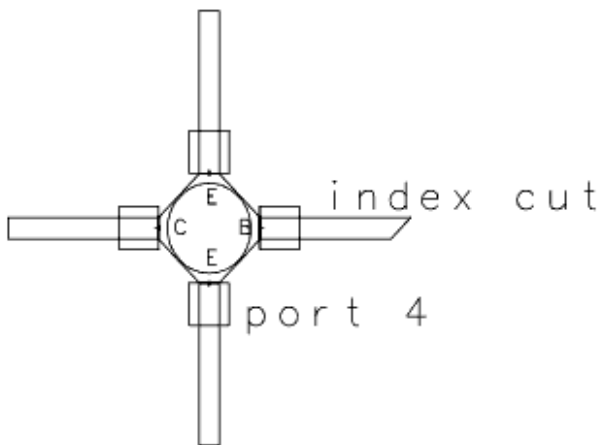

NEC37

NEC37
4 ports
package and hole 149.6 mil diameter
3 leads 23.6 × 157.5 mil, 1 lead 23.6 × 393.7 mil
pads 47.2 mil square
BJT

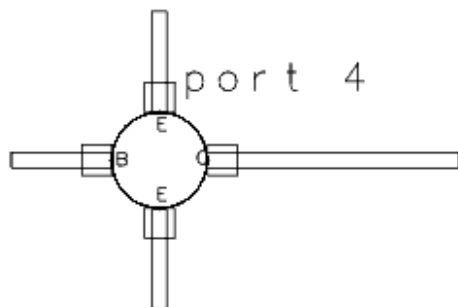

NEC38

NEC38
 4 ports
 SMT
 package 70 mil octagon
 leads 20 × 43.5 mil
 pads 20 mil square
 FET

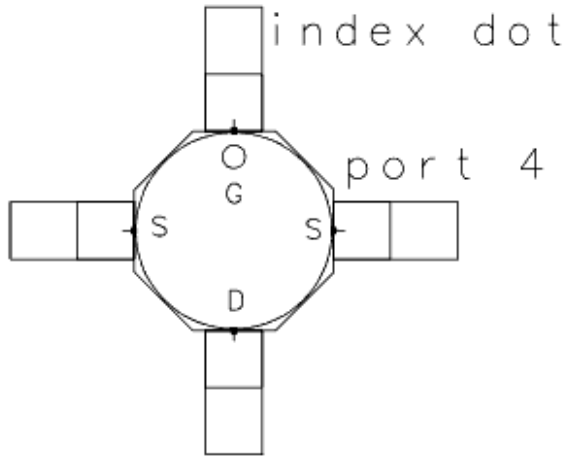

NEC39

NEC39
 4 ports
 SMT
 package 59.1 × 114.2 mil
 3 leads 15.7 × 25.6 mil, 1 lead 23.6 × 25.6 mil
 pads are leads 10 mil xy
 BJT

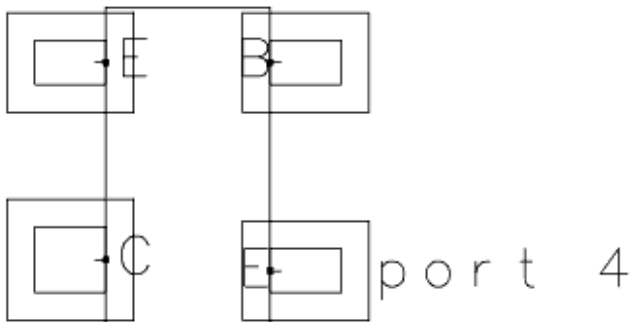

NEC53E

NEC53E
 3 ports

flange 800 × 250 mil
 holes 130 mil diameter 563 mil center-to-center
 1 lead 30 × 210 mil, 1 lead 115 × 210 mil
 1 pad 30 mil square, 1 pad 115 mil square
 BJT

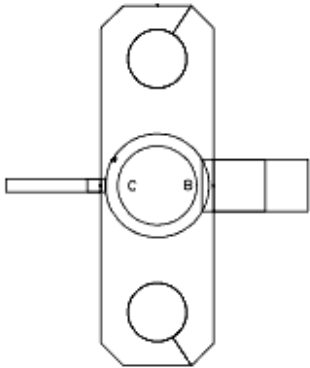

NEC75

NEC75
 3 ports
 flange 385.8 × 90.6 mil
 holes 70.8 mil diameter 275.6 mil center-to-center
 2 leads 19.6 × 118.1 mil
 2 pads 19.6 mil square
 FET

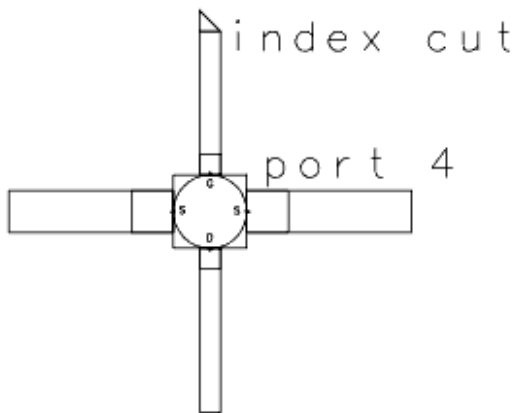

NEC83

NEC83
 4 ports
 SMT
 package 70 mil square
 2 leads 40 × 157.5 mil, 2 leads 20 × 157.5 mil
 2 pads 40 mil square, 2 pads 20 mil square
 FET

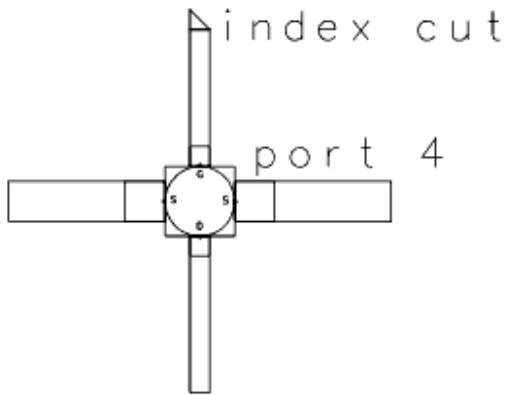

NEC84

NEC84
4 ports
SMT
package 70 mil octagon
leads 20 × 157.5 mil
pads 20 mil square
FET

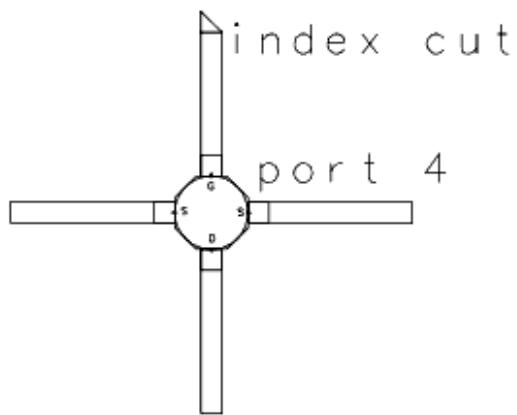

NEC84A

NEC84A
4 ports
SMT
package 70 mil octagon
leads 20 × 157.5 mil
pads 20 mil square
FET

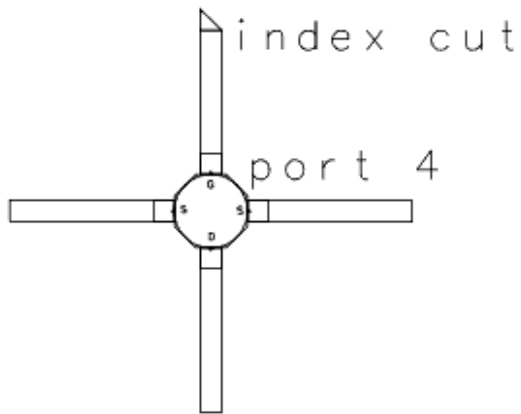

NEC87

NEC87
 3 ports
 package 114.2 × 137.8 mil octagon
 2 leads 23.6 × 196.9 mil
 2 pads 23.6 mil square
 collector on bottom
 BJT

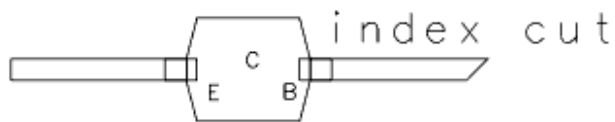

NEC89

NEC89
 4 ports
 SMT
 package 80 mil octagon
 2 leads 80 × 157.5 mil, 2 leads 20 × 157.5 mil
 2 pads 20 mil square, 2 pads 80 mil square
 FET

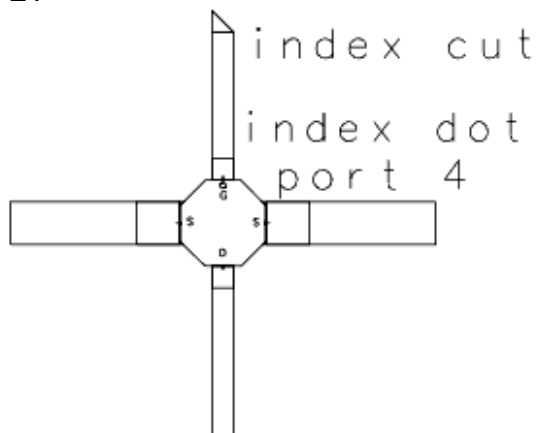

NEC89A

NEC89A

4 ports

SMT

package 80 mil octagon

2 leads 80 × 157.5 mil, 2 leads 20 × 157.5 mil

2 pads 20 mil square, 2 pads 80 mil square

FET

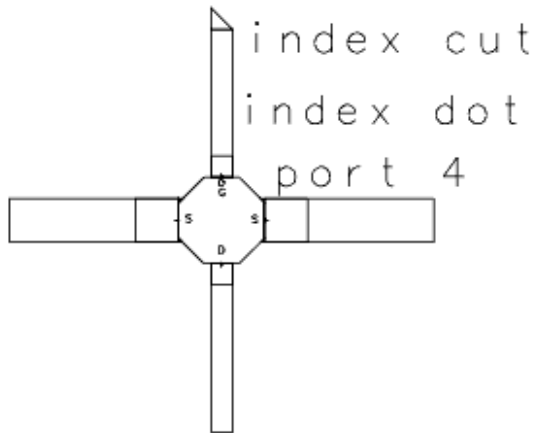

OKI_1

(no name given by vendor)

3 ports

package and hole 130 × 185 mil

2 leads 19.7 × 78.8 mil

2 pads 19.7 mil square

2 support bars 5 × 20 mil

FET

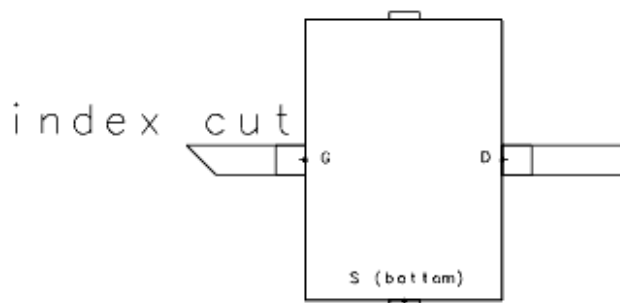

PFLANGE

(no name given by vendor)

5 ports

flange 820 × 250 mil

holes 120 mil diameter 570 mil center-to-center

leads 60 × 200 mil

pads 60 mil square
FET

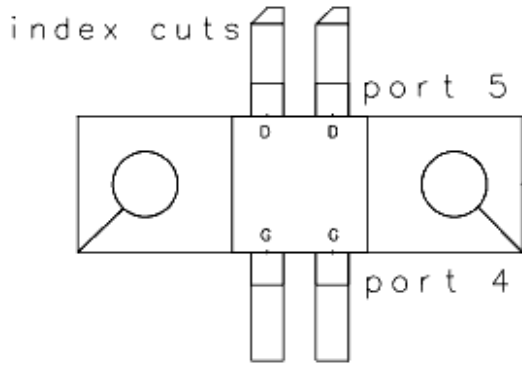

RADIAL_L

Radial leded components
2 ports 400 mil port-to-port
packages 140 × 480 mil
leads 28 mil diameter

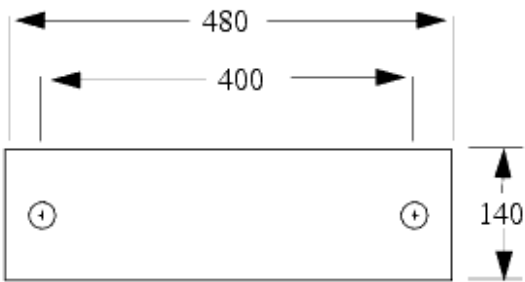

RADIAL_M

Radial leded components
2 ports 200 mil port-to-port
packages 90 × 290 mil
leads 28 mil diameter

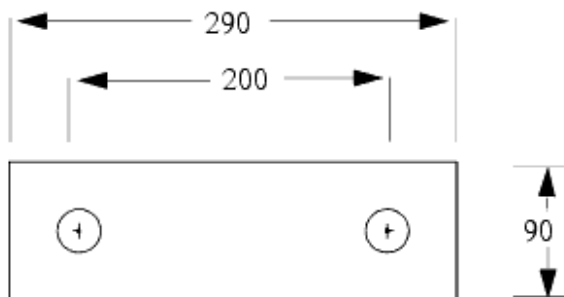

RADIAL_S

Radial leaded components
 2 ports 200 mil port-to-port
 packages 90 × 190 mil
 leads 28 mil diameter

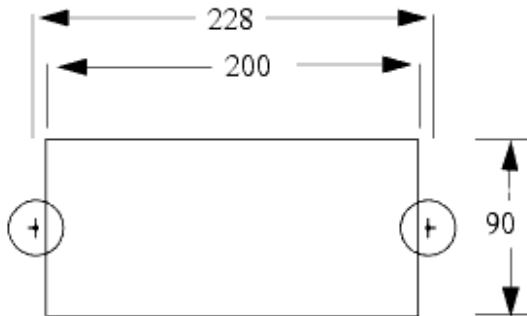

RESA

Chip resistor
 2 ports 30 mil port-to-port
 packages 20 × 30 mil
 resi 20 × 50 mil

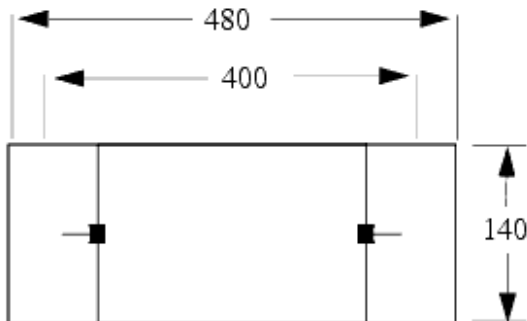

SFLANGE

(no name given by vendor)
 4 ports
 flange 975 × 250 mil
 package 380 mil diameter
 holes 120 mil diameter 725 mil center-to-center
 leads 220 × 210 mil at 45°
 pads 220 × 210 mil
 FET

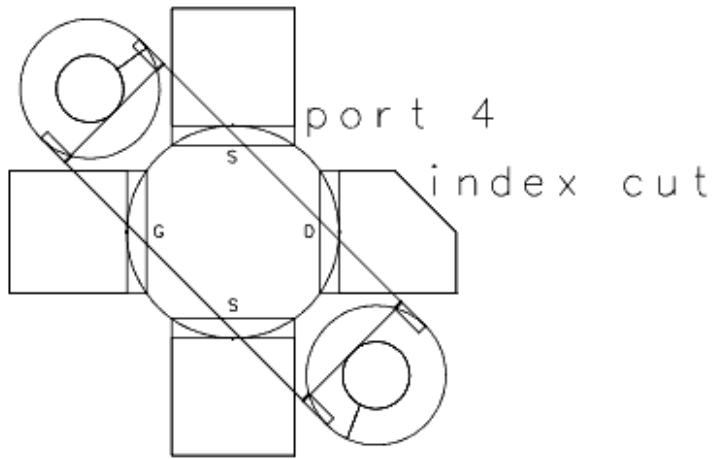

SMA_FEM

SMA connector outline female
 no ports
 conductor
 cond2
 leads

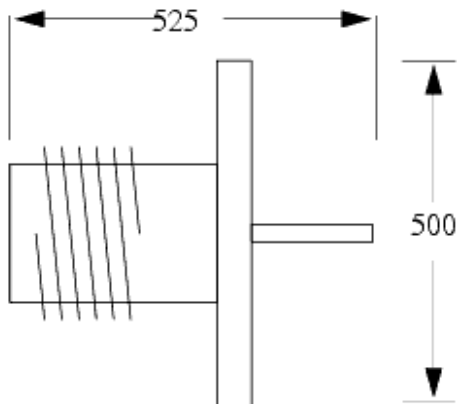

SMSMICROX

Siemens MICRO-X
 4 ports
 SMT
 package 70 mil octagon
 2 leads 20 × 47.5 mil, 2 leads 40 × 47.5 mil
 2 pads 20 mil square, 2 pads 40 mil square
 FET
 WARNING: NOT identical to MICROX

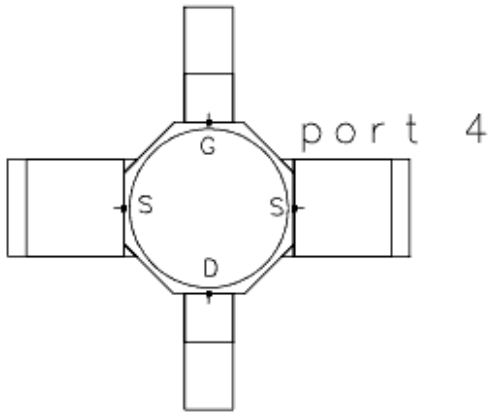

SOD80

SOD80

2 ports

SMT

package 63×137.8 mil

2 leads 11.8×63 mil

2 pads 31.8×83 mil

Diode

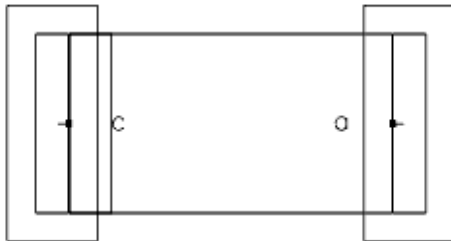

SOD123

SOD123

2 ports

SMT

package 61×106.3 mil

2 leads 19.7×23.6 mil

2 pads 39.7×43.6 mil

Diode



SOD323

SOD323

2 ports

SMT

package 49.2×98.6 mil

2 leads 11.8×15.8 mil

2 pads 31.8×35.8 mil

Diode



SOT23

SOT23

3 ports

SMT

package 115×51 mil

leads 16.5×21.5 mil

pads 41.5×39.4 mil

BJT

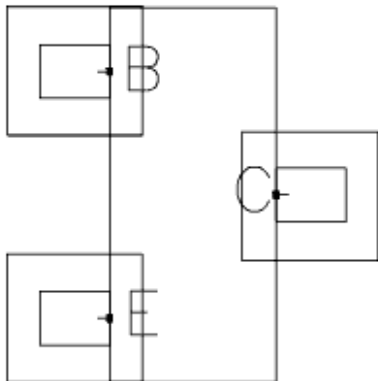

SOT23V2

SOT23

2 ports

SMT
 package 115 × 51 mil
 leads 16.5 × 21.5 mil
 pads 41.5 × 39.4 mil
 Diode

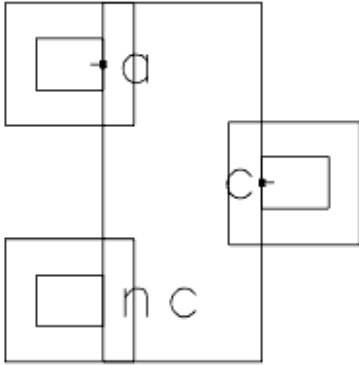

SOT23V3

SOT23
 2 ports
 SMT
 package 115 × 51 mil
 leads 16.5 × 21.5 mil
 pads 41.5 × 39.4 mil
 Diode

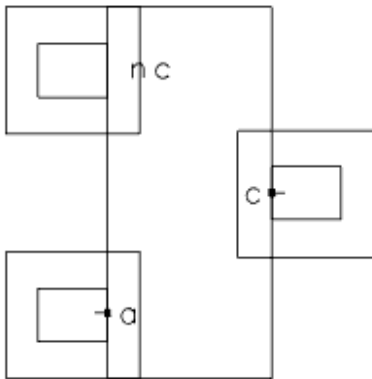

SOT23V4

SOT23
 2 ports
 SMT
 package 115 × 51 mil
 leads 16.5 × 21.5 mil
 pads 41.5 × 39.4 mil
 Diode

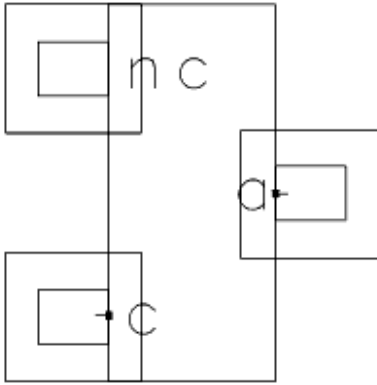

SOT23V5

SOT23

3 ports

SMT

package 115 × 51 mil

leads 16.5 × 21.5 mil

pads 41.5 × 39.4 mil

Diode

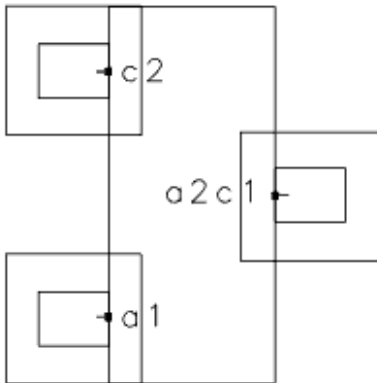

SOT23V6

SOT23

3 ports

SMT

package 115 × 51 mil

leads 16.5 × 21.5 mil

pads 41.5 × 39.4 mil

Diode

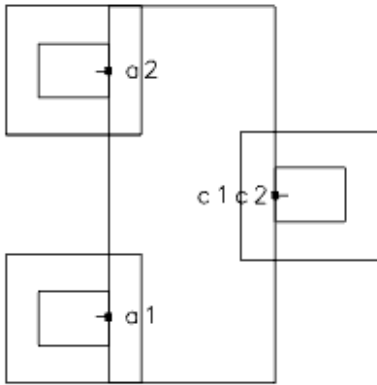

SOT23V7

SOT23
 3 ports
 SMT
 package 115 × 51 mil
 leads 16.5 × 21.5 mil
 pads 41.5 × 39.4 mil
 Diode

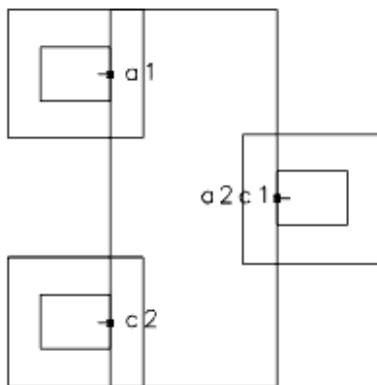

SOT23V8

SOT23
 3 ports
 SMT
 package 115 × 51 mil
 leads 16.5 × 21.5 mil
 pads 41.5 × 39.4 mil
 Diode

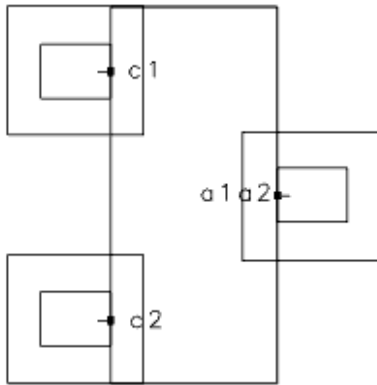

SOT37

SOT37

3 ports

package and hole 189 mil diameter

2 leads 41.3 × 200.8 mil

1 lead 41.3 × 318.9 mil

pads 82.6 mil square

BJT

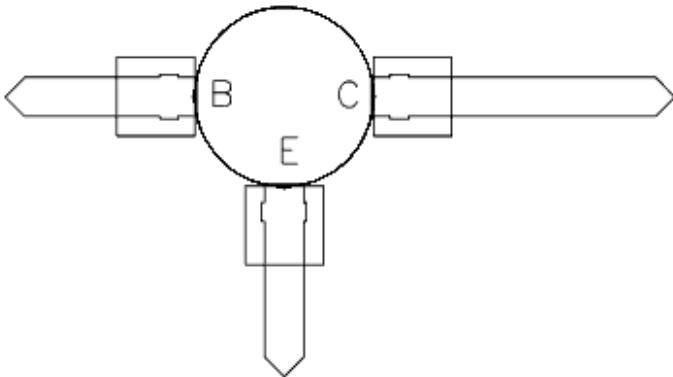

SOT89

SOT89

3 ports

SMT

package 177.2 × 97.7 mil

2 leads 16.5 × 33.1 mil

collector lead 18.6 × 33.1 mil and 27.6 × 64.64 mil

2 pads 59.1 × 39.4 mil

BJT

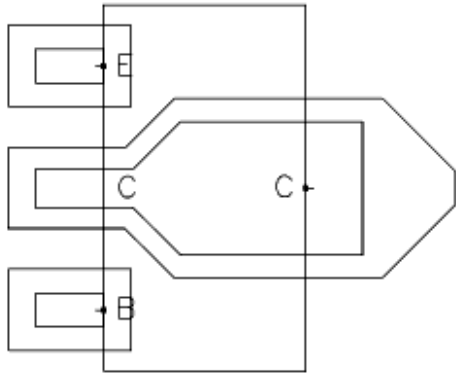

SOT89V2

SOT89

3 ports

SMT

package 177.2×97.7 mil

2 leads 16.5×33.1 mil

collector lead 18.6×33.1 mil and 27.6×64.64 mil

2 pads 59.1×39.4 mil

BJT

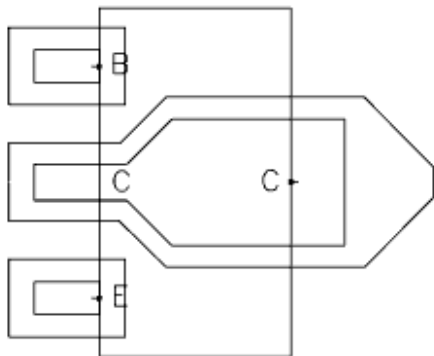

SOT103

SOT103

4 ports

package and hole 189 mil diameter

3 leads 45.3×200.8 mil

1 lead 45.3×318.9 mil

pads 90.6 mil square

BJT

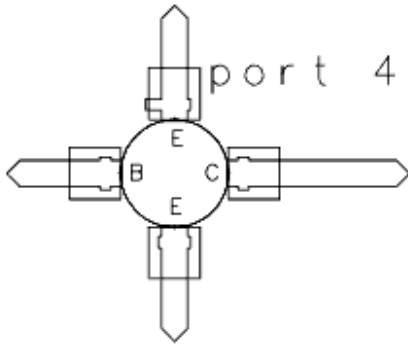

SOT143

SOT143

4 ports

SMT

package 51 × 115 mil

3 leads 16 × 20 mil, 1 lead 32 × 20 mil

3 pads 40 × 39.4 mil, 1 pad 55.2 × 40 mil

BJT

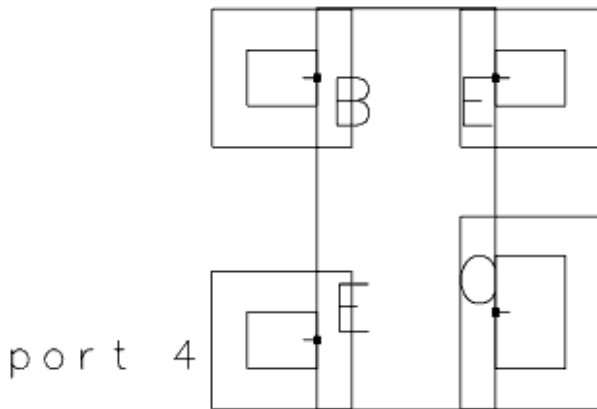

SOT143R

SOT143R

4 ports

SMT

package 51 × 115 mil

3 leads 16 × 20 mil, 1 lead 32 × 20 mil

3 pads 40 × 39.4 mil, 1 pad 55.2 × 40 mil

BJT

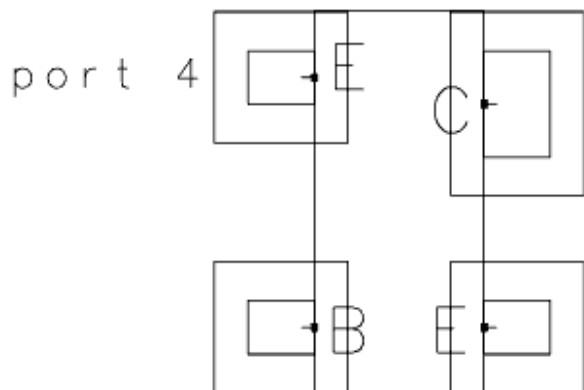

SOT143RV2

SOT143

4 ports

SMT

package 51 × 115 mil

3 leads 16 × 20 mil, 1 lead 32 × 20 mil

3 pads 40 × 39.4 mil, 1 pad 55.2 × 40 mil

BJT

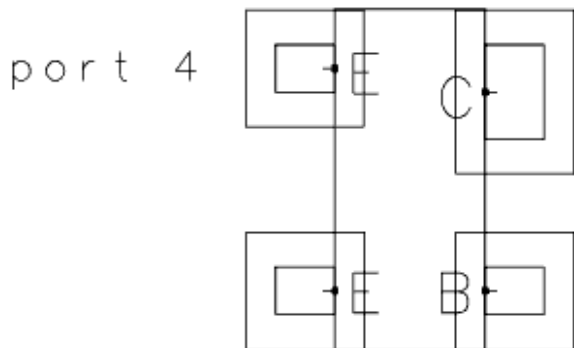

SOT143V2

SOT143

4 ports

SMT

package 51 × 115 mil

3 leads 16 × 20 mil, 1 lead 32 × 20 mil

3 pads 40 × 39.4 mil, 1 pad 55.2 × 40 mil

BJT

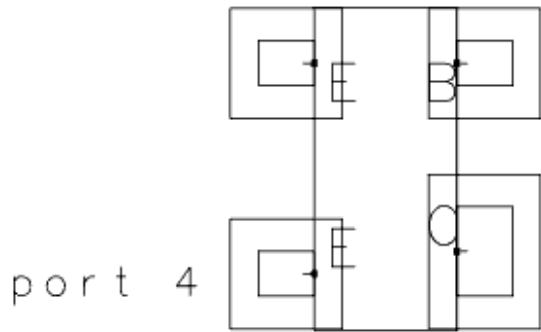

SOT143V3

SOT143

4 ports

SMT

package 51 × 115 mil

3 leads 16 × 20 mil, 1 lead 32 × 20 mil

3 pads 40 × 39.4 mil, 1 pad 55.2 × 40 mil

Diode

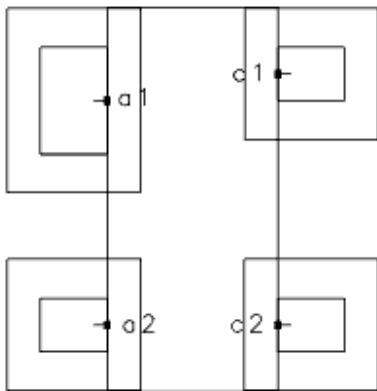

SOT143V4

SOT143

4 ports

SMT

package 51 × 115 mil

3 leads 16 × 20 mil, 1 lead 32 × 20 mil

3 pads 40 × 39.4 mil, 1 pad 55.2 × 40 mil

Diode

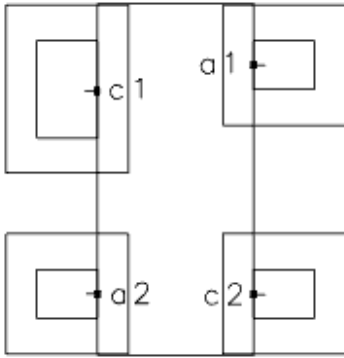

SOT143V5

SOT143

4 ports

SMT

package 51 × 115 mil

3 leads 16 × 20 mil, 1 lead 32 × 20 mil

3 pads 40 × 39.4 mil, 1 pad 55.2 × 40 mil

Diode

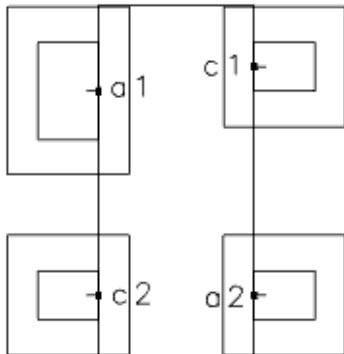

SOT143V6

SOT143

4 ports

SMT

package 51 × 115 mil

3 leads 16 × 20 mil, 1 lead 32 × 20 mil

3 pads 40 × 39.4 mil, 1 pad 55.2 × 40 mil

Diode

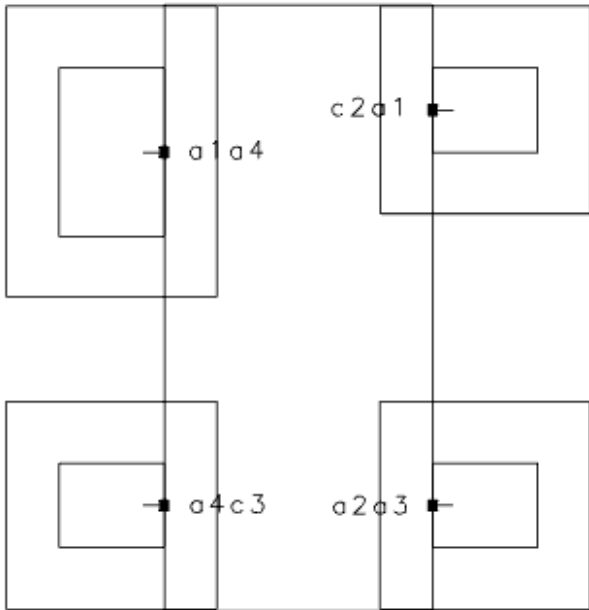

SOT143V7

SOT143

4 ports

SMT

package 51 × 115 mil

3 leads 16 × 20 mil, 1 lead 32 × 20 mil

3 pads 40 × 39.4 mil, 1 pad 55.2 × 40 mil

Diode

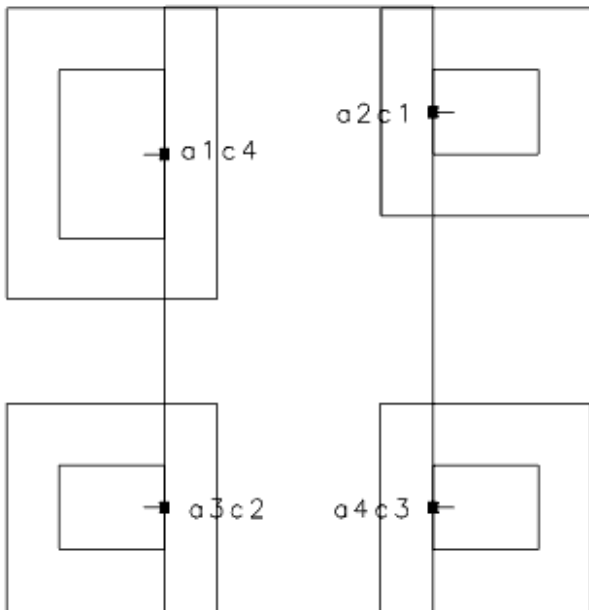

SOT223

SOT223

4 ports
 SMT
 package 255.9 × 137.8 mil
 3 leads 27.6 × 68.9 mil, 1 lead 118.1 × 68.9 mil
 3 pads 98.5 × 59.2 mil, 1 pad 78.9 × 149.6 mil
 BJT

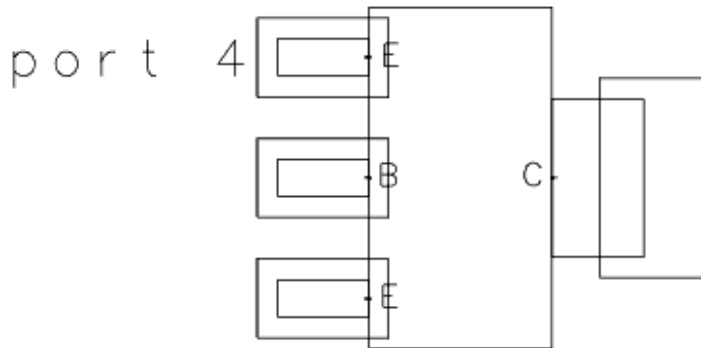

SOT223V2

SOT223
 3 ports
 SMT
 package 255.9 × 137.8 mil
 3 leads 27.6 × 68.9 mil, 1 lead 118.1 × 68.9 mil
 3 pads 98.5 × 59.2 mil, 1 pad 78.9 × 149.6 mil
 Diode

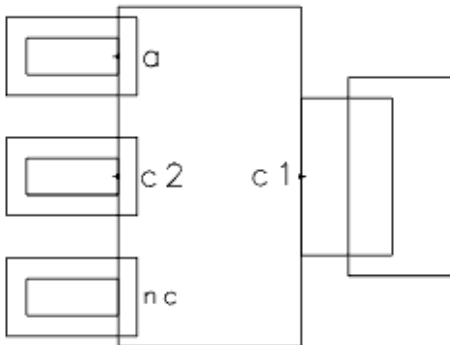

SOT323

SOT323
 3 ports
 SMT
 package 78.6 × 49.4 mil
 leads 11.8 × 16.8 mil
 pads 31.8 × 36.8 mil
 BJT

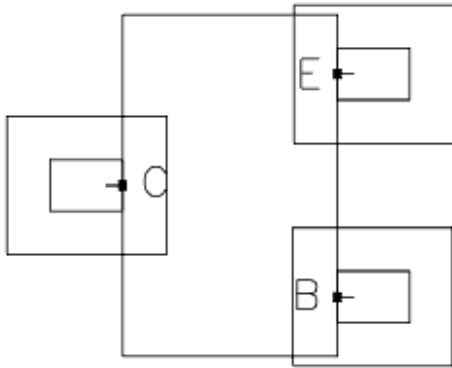

SRP

SRP
2 ports
SMT
package 63 × 104.3 mil
2 leads 22.6 × 23.6 mil
2 pads 42.6 × 43.6 mil
Diode

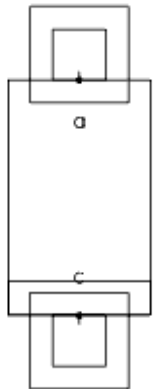

T039

T039
3 ports
package 352.5 mil diameter
holes 21 mil diameter 100 mil from package center
pads 40 mil square
BJT

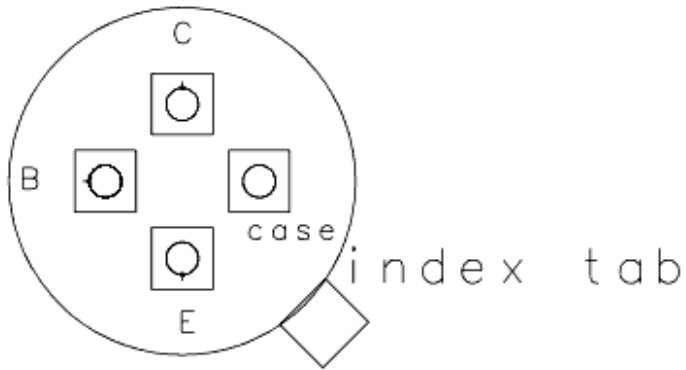

TO72

TO72
3 ports
package 225.4 mil diameter
holes 21 mil diameter 50 mil from center
pads 40 mil square
BJT

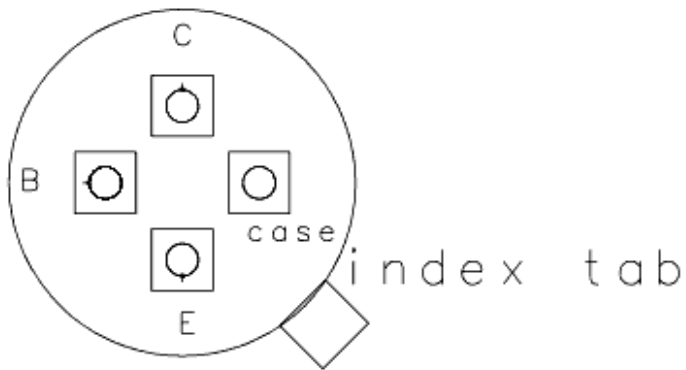

TO72V2

TO72V2
3 ports
package 225.4 mil diameter
holes 21 mil diameter 50 mil from center
pads 40 mil square
BJT

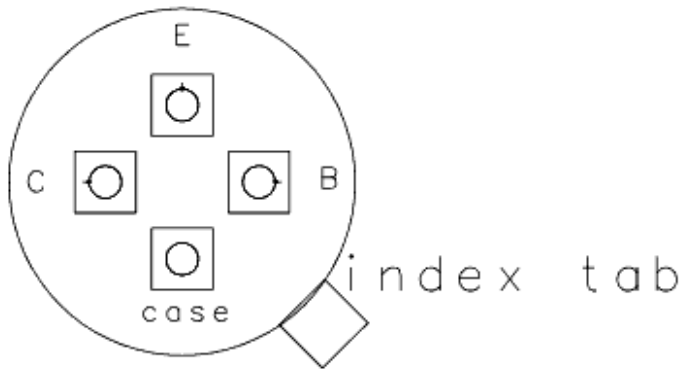

TO92

TO92

3 ports

package 170 mil diameter cut × 135 mil chord

holes 22 mil diameter and 22 × 20 mil

pads 40 mil square

BJT

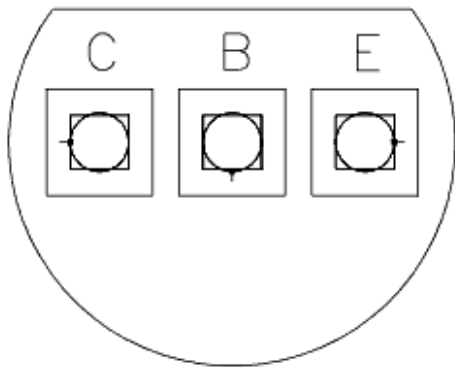

TO117

TO117

4 ports

stud mount package and hole 295.3 diameter

2 leads 157.5 × 393.7 mil, 2 leads 59.1 × 393.7 mil

2 pads 59.1 mil square, 2 pads 157.5 mil square

BJT

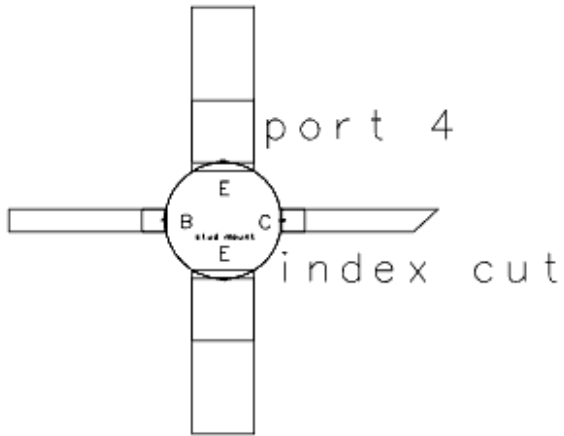

TO206AA

TO206AA
 3 ports
 package 219.5 mil diameter
 holes 21 mil diameter 50 mil from package center
 pads 40 mil square
 BJT

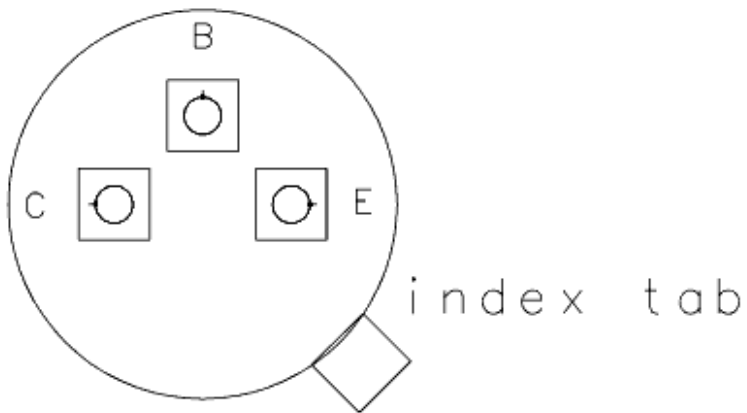

TO206AF

TO206AF
 3 ports
 package 219.5 mil diameter
 holes 21 mil diameter 50 mil from package center
 pads 40 mil square
 BJT

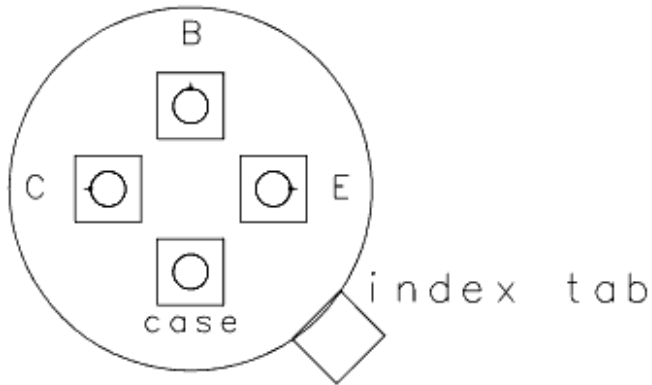

TO226AA

TO226AA

3 ports

package 170 mil diameter cut × 135 mil chord

holes 22 mil diameter and 22 × 20 mil

pads 40 mil square

BJT

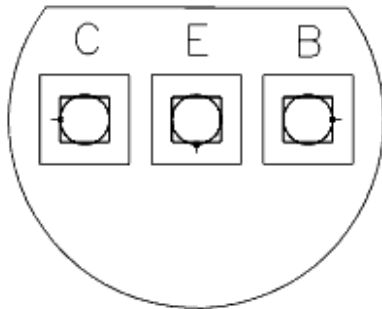

TPLAST

TPLAST

3 ports

package and hole 181.1 mil diameter

2 leads 35.4 × 196.85 mil, 1 lead 35.4 × 315 mil

pads 70.8 mil square

BJT

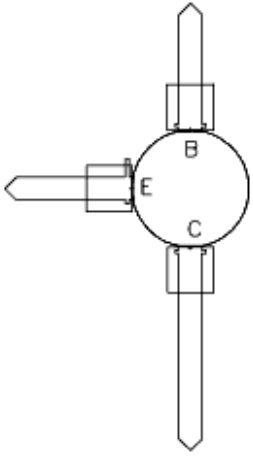

TUNCAP

Tunable chip capacitor
 2 ports 75 mil port-to-port
 leads 110 × 25 mil
 packages 12 × 62
 dielectric 110 × 115

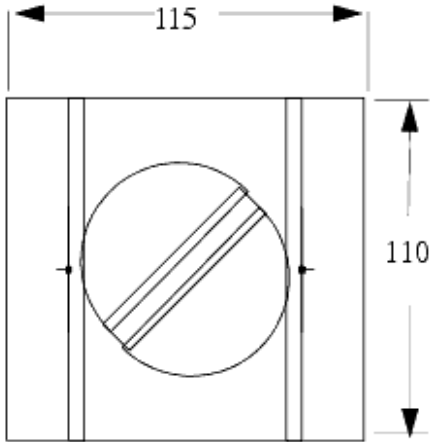

UMD

UMD
 2 ports
 package 63 × 102.4 mil
 2 leads 15.8 × 31.6 mil (bent)
 2 pads 40 mil square
 2 holes 20 mil square
 Diode



UPRIGHT

Upright mounted variable resistor
 no ports
 packages 170 × 250 mil
 Text

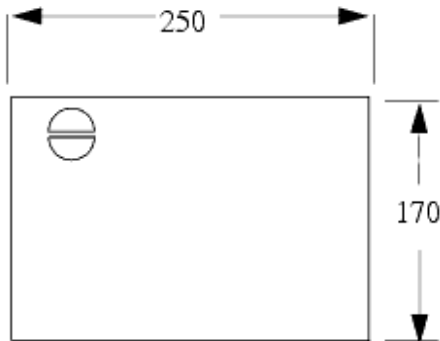

URP

URP
 2 ports
 SMT
 package 52 × 70 mil
 2 leads 10 × 15 mil
 2 pads 30 × 35 mil
 Diode

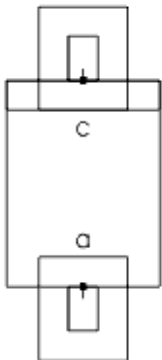

WIRO0

Wire loop outline
 2 ports 133.5 mil port-to-port
 conductor 15 mil wide × 47 mil
 dielectric

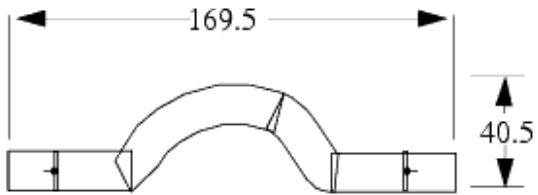

WIRE1

one turn coil outline
2 ports 330 mil port-to-port
dielectric 35 mil wide

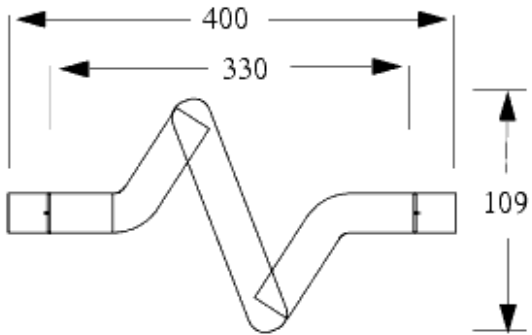

Font Definitions

din17

abcdefghijklmnopqrstuvwxyz
ABCDEFGHIJKLMNOPQRSTUVWXYZ
' 1234567890 - = |
~ ! @ # \$ % ^ & * () _ + \
[] { } < > ; : ' " , . / ?

iso3098

abcdefghijklmnopqrstuvwxyz
ABCDEFGHIJKLMNOPQRSTUVWXYZ
' 1234567890 - = |
~ ! @ # \$ % ^ & * () _ + \
[] { } < > ; : ' " , . / ?

roman

a b c d e f g h i j k l
m n o p q r s t u v w x y z
A B C D E F G H I J K L
M N O P Q R S T U V W X Y Z
□ 1 2 3 4 5 6 7 8 9 0 - = □
□ ! □ □ \$ % ' & * () □ + □
□ □ □ □ □ ' ; : ' " , . / ?

smooth

a b c d e f g h i j k l
m n o p q r s t u v w x y z
A B C D E F G H I J K L
M N O P Q R S T U V W X Y Z
' 1 2 3 4 5 6 7 8 9 0 - = |
□ ! @ # \$ % ^ & * () - + \
[] □ □ < > ; : ' " , . / ?

italic

a b c d e f g h i j k l
m n o p q r s t u v w x y z
A B C D E F G H I J K L
M N O P Q R S T U V W X Y Z
□ 1 2 3 4 5 6 7 8 9 0 - = □
□ ! □ □ \$ □ □ & * () □ + □
[] { } □ □ ; : ' " , . / ?

standard

a b c d e f g h i j k l
m n o p q r s t u v w x y z
A B C D E F G H I J K L
M N O P Q R S T U V W X Y Z
' 1 2 3 4 5 6 7 8 9 0 - = |
~ ! @ # \$ % ^ & * () + \
[] { } < > ; : ' " , . / ?

gothic

a b c d e f g h i j k l
m n o p q r s t u v w x y z
A B C D E F G H I J K L
M N O P Q R S T U V W X Y Z
□ 1 2 3 4 5 6 7 8 9 0 - = □
□ ! ' ' \$ % □ & * () □ + □
□ □ □ □ □ □ ; : ' " , . / ?

math

α β γ δ ε ζ η θ ι κ λ μ
ν ξ ο π ρ σ τ υ φ χ ψ ω θ φ
Α Β Γ Δ Ε Ζ Η Θ Ι Κ Λ Μ
Ν Ξ Ο Π Ρ Σ Τ Υ Φ Χ Ψ Ω ∇ α
. 1 2 3 4 5 6 7 8 9 0 - = √ ∫
≠ √ ∫ ∞ ÷ ≥ ∝ × () + √ ∫
ζ ≠ ω ≡ < > ε e ' " , . / ≈ √ ∫

sans

abcdefghijklmnopghijkl
mnopqrstuvwxyz
ABCDEFGHIJKLMN
OPQRSTUVWXYZ
' 1234567890 - = |
~ ! @ # \$ % ^ & * () _ + \
[] { } < > ; : ' " , . / ?

sansbold

abcdefghijklmnopghijkl
mnopqrstuvwxyz
ABCDEFGHIJKLMN
OPQRSTUVWXYZ
' 1234567890 - = |
~ ! @ # \$ % ^ & * () _ + \
[] { } < > ; : ' " , . / ?

filled

abcdefghijklmnopqrstuvwxyz
ABCDEFGHIJKLMNOPQRSTUVWXYZ
' 1234567890 - = |
~ ! @ # \$ % ^ & * () _ + \
[] { } < > ; : ' " , . / ?

filledbold

abcdefghijklmnopqrstuvwxyz
ABCDEFGHIJKLMNOPQRSTUVWXYZ
' 1234567890 - = |
~ ! @ # \$ % ^ & * () _ + \
[] { } < > ; : ' " , . / ?

straight

abcdefghijklmnopqrstuvwxyz
ABCDEFGHIJKLMNOPQRSTUVWXYZ
MNOPQRSTUVWXYZ
`1234567890-=_|
~!@#\$%^&*()_+\
[] { } < > ; : ' " , . / ?

straightfilled

abcdefghijklmnopqrstuvwxyz
ABCDEFGHIJKLMNOPQRSTUVWXYZ
MNOPQRSTUVWXYZ
`1234567890-=_|
~!@#\$%^&*()_+\
[] { } < > ; : ' " , . / ?

SMT Package Layout Artwork Library

The SMT Package Layout Artwork Library (SMT PAL) defines the SMT package artwork for some of the most commonly-used packages. The SMT PAL consists of 131 artwork packages of 7 different types:

- Ceramic Flat Pack (CFP)
- Chip and MELF components
- SOT, DPAK and D2PAK
- Plastic Flat Pack (PFP)
- Quad Flat Pack (QFP)
- Plastic Leaded Chip Carrier (PLCC)
- Small Outline IC (SOIC)

This section describes the library, including the package type and name, the AEL interface function name (AEL macro name), and the dimensions of the package. A diagram is shown for each package type.

This section also describes how you can use the SMT PAL to define the SMT package artwork in a custom *create_item* and how you can use the AEL macro name defining the package artwork as an artwork replacement for sub-circuits or sub-systems.

Using SMT Package Artwork as Artwork Replacement

The procedure for using the SMT package artwork as an artwork replacement is similar to using the standard artwork replacements. In the Design Parameters dialog box, change the artwork type to AEL macro and define the two parameters, SMT_Pad and OFFSET. Set the SMT_Pad parameter type to *string*.

[SMT Artwork Replacement Examples](#) shows an example for using the SMT package layout artwork library AEL function as an artwork replacement, through the Parametric Subnetwork (PSN). Underlying the network *3PortSubNet* is the element S3P, that can be viewed by pushing into the component. In the Design Parameters dialog for the subnetwork, *3PortSubNet*, the Artwork Type is set to AEL *macro* and Name is set to *smtart_SOT23*. Two parameters, SMT_Pad and OFFSET, are defined in the Design Parameters dialog. Set the SMT_Pad parameter value to *String*, with "*Pad1*" as its default value. Set the OFFSET parameter type to *real*, with *0* as its default value.

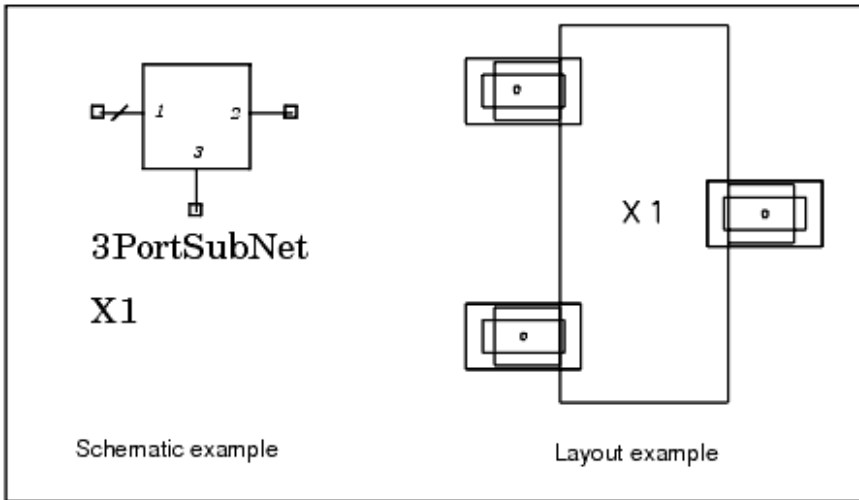

SMT Artwork Replacement Examples

Ceramic Flat Pack (CFP) Packages

[Ceramic Flat Pack \(CFP\) Packages](#) lists 17 CFP packages and the associated layout artwork AEL macro name and dimensions for each package. [Ceramic Flat Pack \(CFP\) Layout Artwork](#) shows the layout artwork for a typical CFP with the marked dimensions given in the table.

Ceramic Flat Pack (CFP) Packages

Advanced Design System 2011.01 - Layout Library

Part Name	AEL Macro Name	Package		Lead		Lead-lead Spacing(mm)
		Width(mm)	Length(mm)	Width(mm)	Length(mm)	
CFP24	smtart_CFP24	15.36	9.65	0.43	7.87	1.27
CFP28	smtart_CFP28	18.78	9.14	0.43	7.87	1.27
CFP42	smtart_CFP42	27.16	16.24	0.43	7.61	1.27
CFP10-03	smtart_CFP10_03	7.36	3.81	0.305	2.74	1.27
CFP14-03	smtart_CFP14_03	9.9	3.81	0.305	2.74	1.27
CFP10-04	smtart_CFP10_04	7.36	6.35	0.431	2.47	1.27
CFP14-04	smtart_CFP14_04	9.9	6.35	0.431	2.47	1.27
CFP16-04	smtart_CFP16_04	11.17	6.35	0.431	2.47	1.27
CFP16-21	smtart_CFP16_21	11.17	13.96	0.431	3.16	1.27
CFP20-22	smtart_CFP20_22	13.71	16.5	0.431	2.89	1.27
CFP24-19	smtart_CFP24_19	16.25	8.88	0.431	3.20	1.27
CFP24-21	smtart_CFP24_21	16.25	13.96	0.431	3.16	1.27
CFP28-19	smtart_CFP28_19	18.79	8.88	0.508	3.20	1.27
CFP36-20	smtart_CFP36_20	23.87	11.42	0.431	2.93	1.27
CFP36-21	smtart_CFP36_21	23.87	13.96	0.431	3.16	1.27
CFP36-23	smtart_CFP36_23	23.87	21.57	0.431	2.86	1.27
CFP40-20	smtart_CFP40_20	26.41	11.42	0.431	2.93	1.27

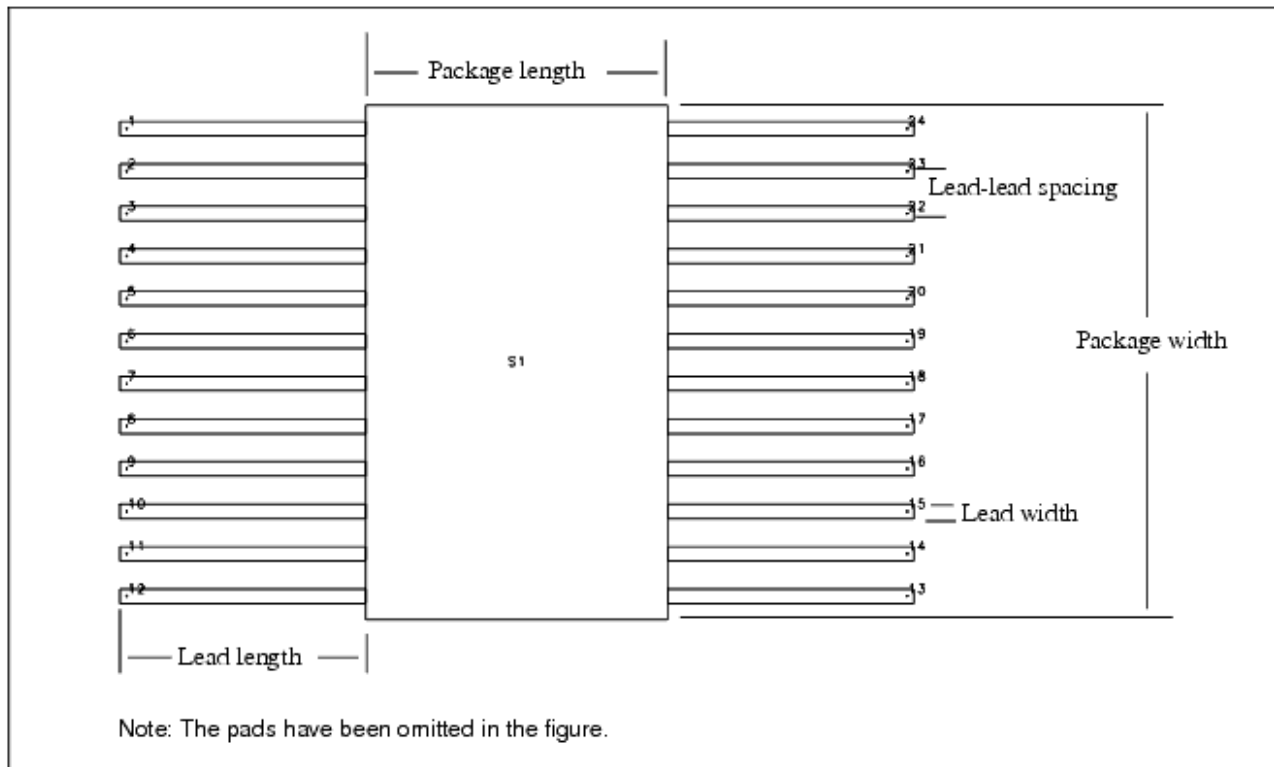

Ceramic Flat Pack (CFP) Layout Artwork

Chip and MELF Components

[Chip and MELF Component Packages](#) lists 15 chip component packages and 4 MELF components, and the associated layout artwork AEL macro name and dimensions for each package. [Chip Component Layout Artwork](#) shows the layout artwork for a typical chip component, 0402, with the marked dimensions given in the table.

Chip and MELF Component Packages

Part Name	AEL Macro Name	Package		End-cap Termination Length(mm)	Description
		Width(mm)	Length(mm)		
0402	smtart_0402	0.508	1.00	0.127	Resistor
0603-Res	smtart_0603R	0.787	1.55	0.305	Resistor
0603-Cap	smtart_0603C	0.787	1.55	0.203	Capacitor
0805	smtart_0805	1.22	2.01	0.457	Resistor or capacitor
1005	smtart_1005	1.27	2.54	0.254	Capacitor
1206	smtart_1206	1.57	3.20	0.558	Resistor or capacitor
1210	smtart_1210	2.49	3.20	0.558	Resistor or capacitor
1805	smtart_1805	1.27	4.57	0.305	Capacitor
1808	smtart_1808	2.03	4.57	0.305	Capacitor
1812	smtart_1812	3.17	4.57	0.305	Capacitor
1825	smtart_1825	6.35	4.57	0.305	Capacitor
2010	smtart_2010	2.54	5.1	0.40	Capacitor
2220	smtart_2220	5.08	5.58	1.27	Capacitor
2225	smtart_2225	6.35	5.58	1.27	Capacitor
2512	smtart_2512	3.2	6.3	0.40	Capacitor
2309	smtart_2309	2.3	5.9	1.0	MELF
1406	smtart_1406	1.55	3.5	0.80	MELF
SOD-80	smtart_SOD80	1.60	3.5	0.431	MELF
SOD-87	smtart_SOD87	1.6	3.5	0.30	MELF

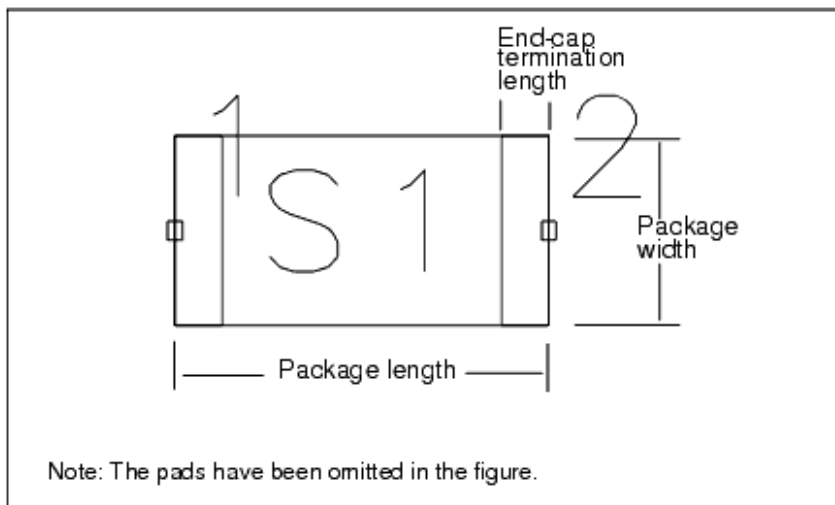

SOT, DPAK, D2PAK Packages

[SOT, DPAK, D2PAK Packages](#) lists 20 SOT, DPAK, and D2PAK packages and the associated layout artwork AEL macro name and dimensions for each package.

Most packages require two parameters, SMT_Pad and OFFSET. Packages that require two SMT_Pad parameters are indicated by an asterisk (*). If lead 1 (e.g., SOT143) is of a different dimension than the other leads, the first SMT_Pad identifies lead 1. If a lead other than lead 1 (e.g., DPAK1) is of a different dimension, then the second SMT_Pad identifies the lead of a different dimension.

[SOT-23 Layout Artwork](#) shows the layout artwork for a typical SOT-23 package with the marked dimensions given (in mm) in the table.

[SOT, DPAK, D2PAK Packages \(dimensions in mm\)](#)

Advanced Design System 2011.01 - Layout Library

Part Name	AEL Macro Name	Package		Lead 1		Other Leads		Lead-lead Spacing	
		Width (mm)	Length (mm)	Width (mm)	Length (mm)	Width (mm)	Length (mm)	Side 1 (mm)	Side 2 (mm)
SOT-23	smtart_SOT23	2.92	1.30	0.45	0.51	0.45	0.51	1.90	N/A
SOT-23, Metric	smtart_SOT23M1	2.92	1.50	0.45	0.50	0.45	0.50	1.90	N/A
SOT-23, Metric	smtart_SOT23M2	2.92	1.50	0.45	0.65	0.45	0.65	1.90	N/A
SOT-23, Metric	smtart_SOT23M3	1.60	0.80	0.30	0.40	0.30	0.40	1.00	N/A
SOT-23, Metric	smtart_SOT23M4	2.00	1.25	0.30	0.43	0.30	0.43	1.30	N/A
SOT-23, Metric	smtart_SOT23M5	2.90	1.30	0.40	0.55	0.40	0.55	1.90	N/A
SOT-25	smtart_SOT25A	2.92	1.50	0.30	0.65	0.30	0.54	1.90	0.95
SOT-25	smtart_SOT25B	2.00	0.90	0.20	0.60	0.20	0.60	1.30	0.65
SOT-25	smtart_SOT25C	2.00	1.25	0.20	0.43	0.20	0.43	0.65	0.65
SOT-25	smtart_SOT2 5D	2.90	1.60	0.30	0.60	0.30	0.60	0.95	0.95
SOT-36	smtart_SOT36	2.90	1.60	0.30	0.60	0.30	0.60	0.95	0.95
SOT-143*	smtart_SOT143A	2.90	1.30	0.88	0.75	0.48	0.75	1.70	1.90
SOT-143*	smtart_SOT143B	2.90	1.30	0.88	0.60	0.48	0.60	1.70	1.90
SOT-223*	smtart_SOT223	6.50	3.50	3.00	1.75	0.74	1.75	2.30	N/A
DPAK*	smtart_DPAK1	5.50	5.50	5.20	2.79	0.51	2.00	4.60	N/A
DPAK*	smtart_DPAK2	5.50	5.50	5.20	12.0	0.51	2.00	2.30	N/A
DPAK*	smtart_DPAK3	6.09	6.09	5.20	2.74	0.79	1.07	4.60	N/A
DPAK*	smtart_DPAK4	5.87	6.10	4.83	2.74	0.79	1.07	4.57	N/A
DPAK*	smtart_DPAK5	8.15	5.82	5.38	4.45	1.14	1.55	4.57	N/A
D2PAK*	smtart_D2PAK	10.41	9.96	0.71	4.83	9.96	1.27	2.54	N/A

Note
An asterisk (*) in above table denotes that the artwork requires 2 SMT_Pad components.

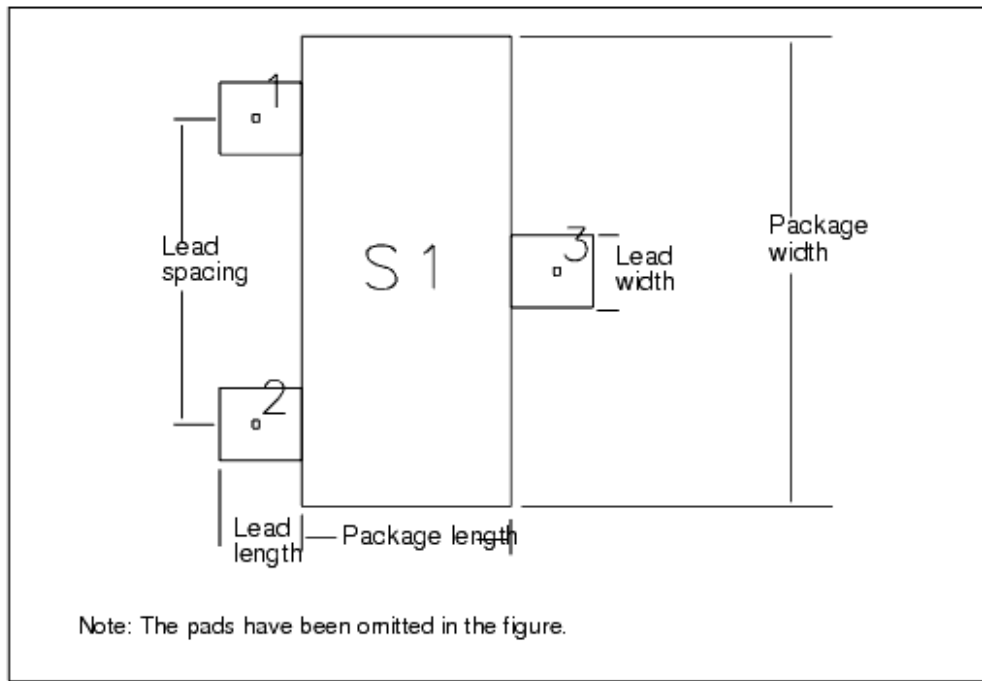

SOT-23 Layout Artwork

Plastic Flat Pack (PFP) Packages

[Plastic Flat Pack \(PFP\) Packages](#) lists 3 Plastic Flat Pack (PFP) packages and the associated layout artwork AEL macro name and dimensions for each package. [Plastic Flat Pack \(PFP\) Layout Artwork](#) shows the layout artwork for a PFP with the marked dimensions given in the table.

Plastic Flat Pack (PFP) Packages

Part Name	AEL Macro Name	Package		Lead		Lead-lead Spacing(mm)
		Width(mm)	Length(mm)	Width(mm)	Length(mm)	
PFP-16	smtart_PFP16	10.18	6.85	0.43	8.88	1.27
PFP-18	smtart_PFP18	11.04	7.79	0.43	7.87	1.27
PFP-20	smtart_PFP20	15.49	9.27	0.43	7.72	1.27

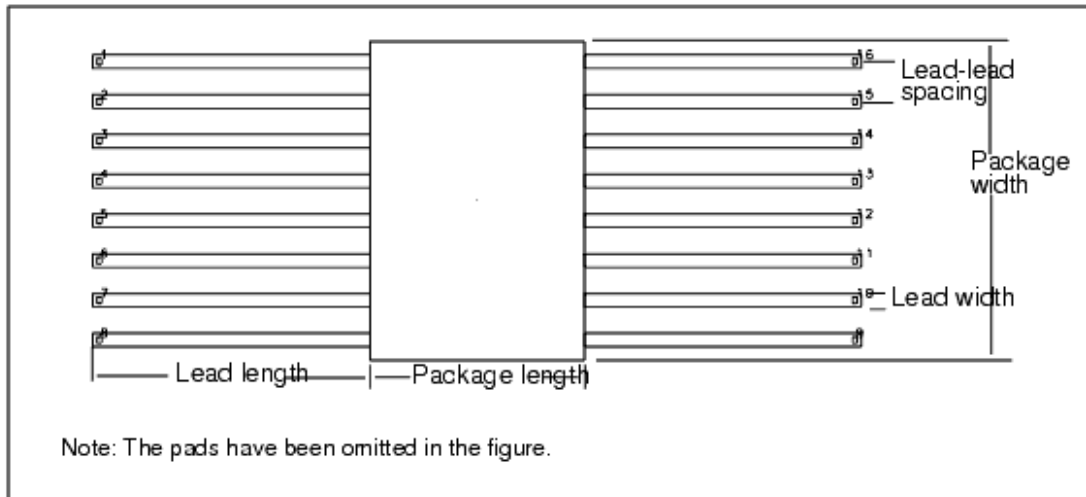

Plastic Flat Pack (PFP) Layout Artwork

Quad Flat Pack (QFP) Packages

[Quad Flat Pack \(QFP\) Packages](#) lists 48 Quad Flat Pack (QFP) and the associated layout artwork AEL macro name and dimensions for each package. [Quad Flat Pack \(QFP\) Layout Artwork](#) shows the layout artwork for a typical QFP package with the marked dimensions given in the table.

Quad Flat Pack (QFP) Packages

Part Name	AEL Macro Name	Package		Lead		Lead-lead Spacing (mm)	Description
		Width (mm)	Length (mm)	Width (mm)	Length (mm)		
QFP32A	smtart_QFP32A	7.0	7.0	0.3	1.0	0.8	8 leads/side
QFP32B	smtart_QFP32B	5.0	5.0	0.2	1.0	0.5	8 leads/side
QFP40A	smtart_QFP40A	6.0	6.0	0.2	1.0	0.5	10 leads/side
QFP40B	smtart_QFP40B	5.0	5.0	0.15	1.0	0.4	10 leads/side
QFP40C	smtart_QFP40C	7.0	5.0	0.2	1.0	0.5	12 × 8 leads
QFP44A	smtart_QFP44A	10.5	11.5	0.3	1.5	0.8	11 leads/side
QFP44B	smtart_QFP44B	10.1	10.1	0.3	1.1	0.8	11 leads/side
QFP44C	smtart_QFP44C	10.6	10.6	0.3	1.9	0.8	11 leads/side
QFP44D	smtart_QFP44D	10.0	10.0	0.3	1.61	0.8	11 leads/side
QFP44E	smtart_QFP44E	10.0	10.0	0.41	1.99	0.8	11

Advanced Design System 2011.01 - Layout Library

							leads/side
QFP44F	smtart_QFP44F	14.0	14.0	0.35	1.61	1.0	11 leads/side
QFP48A	smtart_QFP48A	12.7	12.7	0.3	2.3	0.8	12 leads/side
QFP48B	smtart_QFP48B	12.0	12.0	0.3	1.65	0.8	12 leads/side
QFP48C	smtart_QFP48C	7.0	7.0	0.2	1.0	0.5	12 leads/side
QFP48D	smtart_QFP48D	6.0	6.0	0.15	1.0	0.4	12 leads/side
QFP52A	smtart_QFP52A	16.7	16.7	0.3	2.3	1.0	13 leads/side
QFP52B	smtart_QFP52B	10.0	10.0	0.3	1.61	0.65	13 leads/side
QFP52C	smtart_QFP52C	10.0	10.0	0.3	2.05	0.65	13 leads/side
QFP52D	smtart_QFP52D	7.0	5.0	0.15	1.0	0.40	16 × 10 leads
QFP54	smtart_QFP5	11.2	11.2	0.3	1.6	0.65	14 × 13 leads
QFP56	smtart_QFP56	11.5	12.5	0.3	1.5	0.65	14 leads/side
QFP60A	smtart_QFP60A	14.0	14.0	0.4	2.1	0.8	15 leads/side
QFP60B	smtart_QFP60B	10.0	7.0	0.2	1.0	0.5	12 × 18 leads
QFP64A	smtart_QFP64A	15	15	0.35	1.3	0.8	16 leads/side
QFP64B	smtart_QFP64B	19.4	15	0.4	1.3	1.0	13 × 19 leads
QFP64C	smtart_QFP64C	15.3	15.3	0.35	1.5	0.8	16 leads/side
QFP64D	smtart_QFP64D	21.3	15.3	0.41	1.7	1.0	13 × 19 leads
QFP64E	smtart_QFP64E	22.8	22.8	0.457	10.15	1.27	16 leads/side
QFP64F	smtart_QFP64F	14.0	14.0	0.381	1.61	0.8	13 × 19 leads
QFP64G	smtart_QFP64G	14.0	14.0	0.356	1.18	0.8	16 leads/side
QFP64H	smtart_QFP64H	20.0	14.0	0.432	1.61	1.0	13 × 19 leads
QFP64I	smtart_QFP64I	7.0	7.0	0.15	1.0	0.4	16 leads/side
QFP70	smtart_QFP70	23.6	10.4	0.3	2.5	0.8	11 × 24 leads
QFP72	smtart_QFP72	10.0	10.0	0.2	1.0	0.5	18 leads/side

Advanced Design System 2011.01 - Layout Library

QFP74	smtart_QFP74	20.6	20.6	0.4	1.3	1.0	18 × 19 leads
QFP76	smtart_QFP76	10.0	7.0	0.15	1.0	0.4	15 × 23 leads
QFP80A	smtart_QFP80A	14.0	14.0	0.3	1.6	0.65	20 leads/side
QFP80B	smtart_QFP80C	20.0	14.0	0.35	1.8	0.8	16 × 24 leads
QFP80C	smtart_QFP80C	20.0	14.0	0.35	2.35	0.8	16 × 24 leads
QFP80D	smtart_QFP80D	14.0	14.0	0.3	1.18	0.65	20 × 20 leads/side
QFP80E	smtart_QFP80E	20.0	14.0	0.36	2.1	0.8	16 × 24 leads
QFP80F	smtart_QFP80F	20.0	14.0	0.36	1.6	0.8	16 × 24 leads
QFP80G	smtart_QFP80G	12.0	12.0	0.203	1.0	0.5	20 × 20 leads/side
QFP88A	smtart_QFP88A	20.0	14.0	0.3	2.5	0.65	18 × 26 leads
QFP88B	smtart_QFP88B	12.0	12.0	0.2	1.0	0.5	22 leads/side
QFP88C	smtart_QFP88C	10.0	10.0	0.15	1.0	0.4	22 leads/side
QFP88D	smtart_QFP88D	14.0	10.0	0.2	1.0	0.5	18 × 26 leads
QFP94	smtart_QFP94	20.6	20.6	0.35	1.3	0.8	23 × 24 × 23 × 24 leads

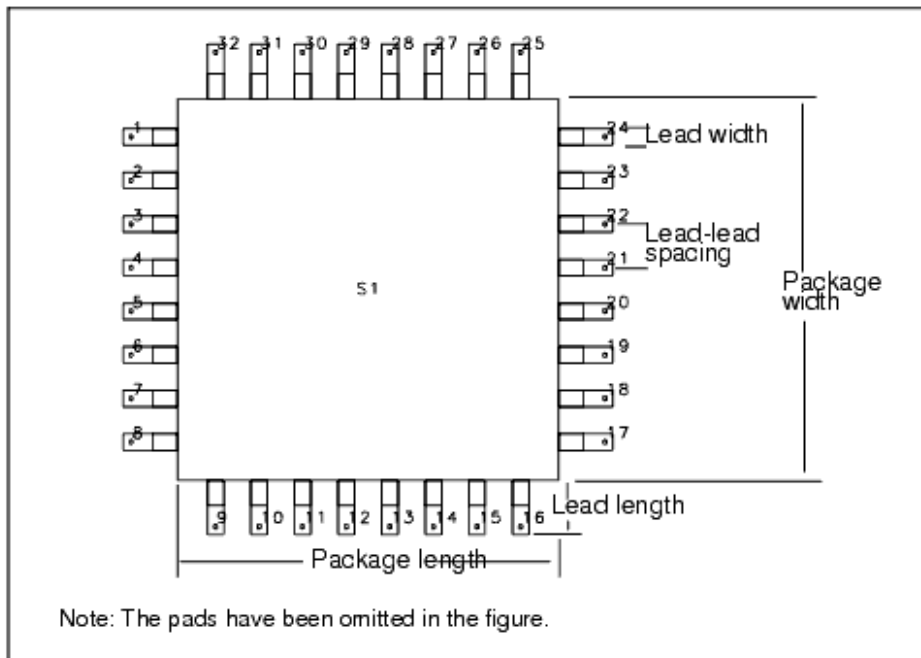

Quad Flat Pack (QFP) Layout Artwork

Plastic Leaded Chip Carrier (PLCC)

[Plastic Leaded Chip Carrier \(PLCC\) Packages](#) lists 11 Plastic Leaded Chip Carrier (PLCC) packages and the associated layout artwork AEL macro name and dimensions for each package. [Plastic Leaded Chip Carrier \(PLCC\) Layout Artwork](#) shows the layout artwork for a typical PLCC package with the marked dimensions given in the table.

Plastic Leaded Chip Carrier (PLCC) Packages

Part Name	AEL Macro Name	Package		Lead	Lead-lead Spacing(mm)
		Width(mm)	Length(mm)	Width(mm)	
PLCC18AA	smtart_PLCC18A A	10.85	7.32	0.431	1.27
PLCC18AB	smtart_PLCC18 AB	12.52	7.42	0.431	1.27
PLCC20SQ	smtart_PLCC20 SQ	8.13	8.13	0.431	1.27
PLCC22RT	smtart_PLCC22 RT	11.62	6.54	0.431	1.27
PLCC28RT	smtart_PLCC28 RT	12.94	7.87	0.431	1.27
PLCC28SQ	smtart_PLCC28 SQ	10.67	10.67	0.431	1.27
PLCC32RT	smtart_PLCC32 RT	12.95	10.67	0.431	1.27
PLCC44SQ	smtart_PLCC44 SQ	15.48	15.48	0.431	1.27
PLCC52SQ	smtart_PLCC52 SQ	18.02	18.02	0.431	1.27
PLCC68SQ	smtart_PLCC68 SQ	23.10	23.10	0.431	1.27
PLCC84SQ	smtart_PLCC84 SQ	28.17	28.17	0.431	1.27

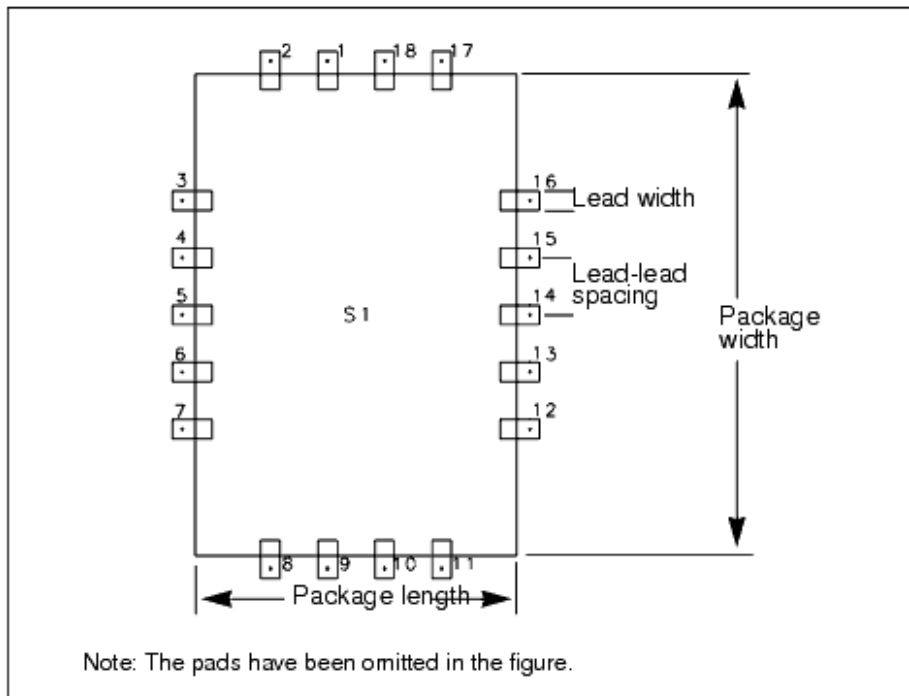

Plastic Leaded Chip Carrier (PLCC) Layout Artwork

Small Outline IC (SOIC)

[Small Outline IC \(SOIC\) Packages](#) lists 13 Small Outline IC (SOIC) packages and the associated layout artwork AEL macro name and dimensions for each package. [Small Outline IC \(SOIC\) Package Layout Artwork](#) shows the layout artwork for a typical SOIC package with the marked dimensions given in the table.

Small Outline IC (SOIC) Packages

Part Name	AEL Macro Name	Package		Lead		Lead-lead Spacing(mm)
		Width(mm)	Length(mm)	Width(mm)	Length(mm)	
SO8N	smtart_SO8N	3.90	4.87	0.432	1.05	1.27
SO14N	smtart_SO14N	3.90	8.63	0.432	1.05	1.27
SO16N	smtart_SO16N	3.90	9.90	0.432	1.05	1.27
SO14M	smtart_SO14M	5.59	9.910	0.432	1.01	1.27
SO16M	smtart_SO16M	5.59	11.20	0.457	1.01	1.27
SO8L	smtart_SO8L	7.50	5.20	0.432	1.40	1.27
SO14L	smtart_SO14L	57.50	9.010	0.432	1.40	1.27
SO16L	smtart_SO16L	7.50	10.30	0.432	1.40	1.27
SO18L	smtart_SO18L	7.50	11.55	0.432	1.40	1.27
SO20L	smtart_SO20L	7.50	12.80	0.432	1.40	1.27
SO24L	smtart_SO24L	7.50	15.37	0.432	1.40	1.27
SO28L	smtart_SO28L	7.50	17.92	0.432	1.40	1.27
SO32L	smtart_SO32L	7.50	20.50	0.432	1.70	1.27

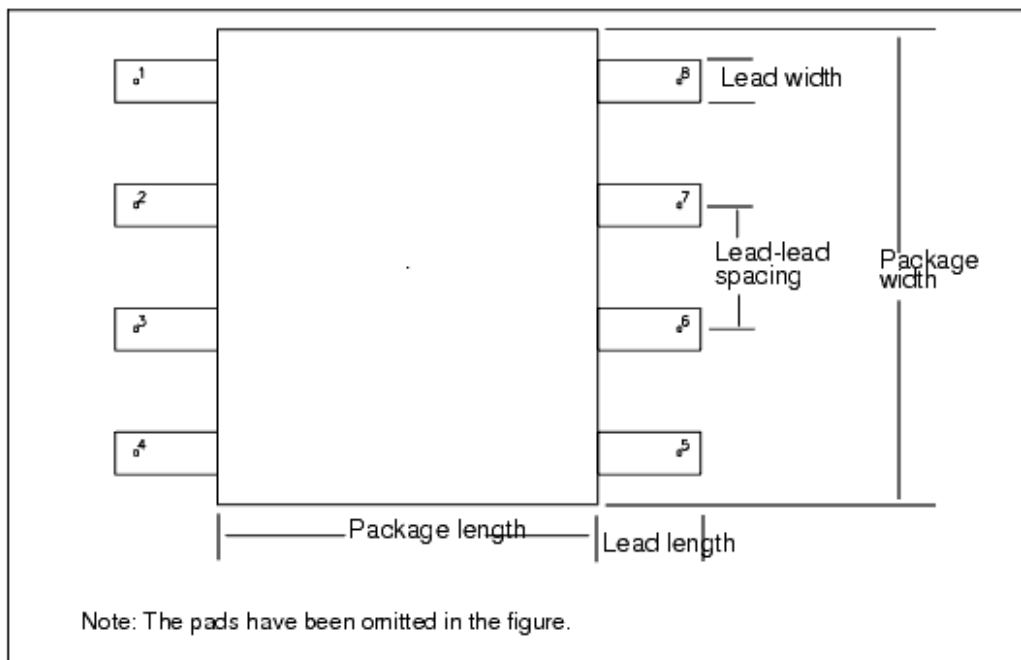

Small Outline IC (SOIC) Package Layout Artwork

Writing Customized SMT PAL Artwork

This section describes how to customize the SMT PAL artwork AEL functions to use in a custom component. Most times, the SMT artwork types in the SMT PAL can be used without any modifications, assuming the dimensions of the artwork match the

requirements. However, sometimes the artwork in the PAL may not match the dimensions required. In this case, the existing AEL code in the SMT PAL could be used to write a customized artwork.

Structure of a SMT PAL artwork

All SMT PAL artwork use an AEL function to describe the artwork. For example, the SOT143A package uses the AEL function `smtart_SOT143A(smtpad1, smtpad2, offset)`. The code for this function is shown below:

```
defun smtart_SOT143A (smtpad1, smtpad2, offset)
{
// Lead 1 and 2 are interchanged in the leadDim_list on Purpose
smtart_draw_SMT(
  list(smtpad1, smtpad2), //list of SMT PAD instance name
  offset,                //pad offset from connecting pin
  0.0013,                //width of package in Units (1.3 mm)
  0.0029,                //Length of package in Units (2.9 mm)
  0,                    //not used
  0,                    //not used
  list(0.0017,0.0,0.0019,0.0), //Lead-to-lead spacing on sides 1,2,3 and 4
                                //of the package in Units

  list(0.00026,0,0.00026,0), //LeadOffset
  list(2,0,2,0),             //Number of leads list
  list(0.00048,0.00075, 0.00088,0.00075, NULL, 0.00048,0.00075,
0.00048,0.00075, NULL, "side1"),
  list(0,0,-90, 0,-0.0017,-90, 0.00232,-0.0017,90, 0.00232,0.0002,90),
//Pins list
  0,                        //Not Used
  "mts",                   //Units
  "portOpt6",              //Package style option
  0,                        //Lead Extension
  NULL
); //smtart_draw_SMT
}
```

The code above calls another function called, `smtart_draw_SMT()`. This is a generic function that is used by all the SMT PAL artworks. An explanation of the arguments used in the generic function `smtart_draw_SMT()` is given in *Arguments for the Generic Function smtart_draw_SMT()* below:

Argument Name	Description
SMT_PAD_list	List of SMT PAD instance name. For example, the SOT143A has 2 pads, one for leads 1, and another one for leads 2, 3, and 4.
Offset	Pad offset from connecting pin.
Width	Width of package (vertical dimension) in Units e.g. 0.0013 for SOT143A
Length	Length of package (horizontal dimension) in Units e.g. 0.0029 for SOT143A
Width1	Not used
Length1	Not used
Spacing	List of 4 lead-to-lead spacing (in Units) on sides 1, 2, 3, and 4.
LeadOffset	List of lead edge offset (in Units) from edge of package for all 4 sides.
NumLeads	List of number of leads on each side of the package.
LeadsDim	List of leads dimensions on all sides (width1, length1, width2, length2, etc.)
PinsList	List of pin parameters on all sides.
DelX	Not used
Units	Dimension units - "um", "mm", "mts", "mil", "in"
PackageStyle	Package style option. The choices are: portOpt1 - SOT23,SOT25,SOT36 portOpt2 - SOIC, CFP, PFP portOpt3 - PLCC portOpt4 - components, MELF portOpt5 - QFP portOpt6 - SOT143, SOT223 portOpt7 - D2PAK portOpt8 - portOpt9 - DPAK2
LeadExt	Lead extension
PortTransList	Not used

Side 1 is the left hand side, 2 to the top, 3 to the right and 4 to the bottom. Pin 1 is always on the left hand side of the package and is drawn at the origin (0,0).

Examples of SMT PAL Artwork Using the Generic Function

Some more examples of SMT PAL artwork using the generic function is given below.

SOIC Artwork

```
defun smtart_SO8N (smtpad, offset)
{
  decl initialDist;
  // all dimensions in mts.
  //initialDist = 0.5 * [Body_length - Lead_width - ((No_leads/2) - 1) *
lead-lead spacing]
  initialDist = 0.5 * (0.00487 - 0.000432 - 3 * 0.00127);
  smtart_draw_SMT(smtpad,offset,0.0039,0.00487,0,0,
    list(0.00127,0,0.00127,0), list(initialDist,0,initialDist,0),
    list(4,0,4,0),list(0.000432,0.00105,0,0,0.000432,0.00105,0,0),
```



```

list(-90.0,1,NULL,NULL,90.0,5,NULL,NULL),0,"mts", "portOpt2",
0,NULL);
}

```

PLCC Artwork

```

defun smtart_PLCC18AA (smtpad, offset)
{
  decl initialDistL, initialDistW, packLength, packWidth, leadExt;
  leadExt = 0.000508;
  packLength = 0.01173 - 2 * leadExt;
  packWidth = 0.00817 - 2 * leadExt;
  // all dimensions in mts.
  initialDistL = 0.5 * (packLength - 0.000432 - 4 * 0.00127);
  initialDistW = 0.5 * (packWidth - 0.000432 - 3 * 0.00127);
  smtart_draw_SMT(smtpad,offset,packWidth,packLength,0,0,
    list(0.00127,0.00127,0.00127,0.00127),
  list(initialDistL,initialDistW,initialDistL,initialDistW),

  list(5,4,5,4),list(0.000432,0.00088,0.000432,0.00085,0.000432,0.00088,0.0004
32,0.00085),
    list(-90.0,3,7, 180,2,18, 90.0,12,16, 0,8,11, 2),0,"mts", "portOpt3",
  leadExt, NULL);
  //elPorts_list =
  list(ang1,nodeStart,nodeStop,ang2,nodeStart,nodeStop,....,node1Position)
}

```

Ceramic Flat Packages (CFP) and Plastic Flat Packages (PFP)

```

defun smtart_CFP24 (smtpad, offset)
{
  decl initialD;
  initialD = 0.5*(0.01536-11*0.00127-0.00043);
  //initialD = {packLength - (#Leads-1)*spacing - leadWidth}/2
  smtart_draw_SMT(smtpad,offset,0.00965,0.01536,0,0,
    list(0.00127,0,0.00127,0), list(initialD,0,initialD,0),
    list(12,0,12,0),list(0.00043,0.00787,0,0,0.00043,0.00787,0,0),
    list(-90.0,1, NULL,NULL, 90.0,13, NULL,NULL),0,"mts", "portOpt2", 0,
  NULL);
}

```

Quad Flat Package (QFP)

```

defun smtart_QFP32A (smtpad, offset)
{
  decl initialD;
  initialD = 0.5*(0.007-7*0.0008-0.0003);
  smtart_draw_SMT(smtpad,offset,0.007,0.007,0,0,
    list(0.0008,0.0008,0.0008,0.0008),

```

Advanced Design System 2011.01 - Layout Library

```
list(initialD,initialD,initialD,initialD),  
  
list(8,8,8,8),list(0.0003,0.001,0.0003,0.001,0.0003,0.001,0.0003,0.001,0.000  
46),  
  list(-90.0,1, 180,32, 90.0,17, 0,9),0,"mts", "portOpt5", 0, NULL);  
}
```